

Technical characteristics

ISV SERIES DISCONNECT SWITCHES

Manufactured according to standard EN 60947-1 (IEC 947-1) EN 60947-3 (IEC 947-3) UL 508, for current up to 100A. The disconnect switches are available in 3 poles and 4 poles with the following functions:
 - Disconnect switch according to EN 60947-3
 - Disconnect switch for direct switching of individual motors according to EN 60947-3.

ISV SERIES GENERAL CHARACTERISTICS

- Body and live parts manufactured from autoextinguishing material VO according to UL 94, resistant to glow wire test at 960° according to IEC 695.2.1 and CEI 50-11, high resistance to arcing.
 - Double gap with positive opening contact of silver alloy.
 - In line screw terminals protected to IP 20 according to VDE 0106 section 100-VGB4.
 - Screw terminals with combination head and autolifting connecting links in the open position ready for wiring.
 - Ease of access to rear terminals in the panel mounting types and to front terminals in the base mounted types.
 - Box supplied complete with clip for DIN rail fixing, DIN 46277/3 EN 50.022.
 - Switching angle 90 degrees.
 - Control devices with degree of protection IP 65.
 ISV series suitable for a side assembly of auxiliary contacts and additional poles.

REQUIREMENTS

Standard EN 60204-1 provides requirements and recommendation relating to the electrical equipment for machines. For correct choice of equipment switches, consideration must be given to applicable regulations. The regulations are described below in general terms but must be considered in more specific detail for most applications.

GENERAL ON-OFF DISCONNECT SWITCH

- Application shall disconnect the electrical equipment of the machine from the supply when required (e.g. during work on the electrical equipment).
 - Must be a disconnect switch in accordance with EN 60947-3, utilization category AC23B.
 - Be provided with a means permitting it to lock in the off position (e.g. by padlocks).
 - Have a breaking capacity sufficient to interrupt the current of the largest motor when stalled, together with the sum of the normal running current of all other motors and/or loads.
 - Its operating handle shall not be red. Black or grey is recommended.

EMERGENCY STOP SWITCH

- It shall override all other functions and operations in all modes.
 - Power to the machine actuators that can cause hazardous conditions shall be removed as quickly as possible without creating other hazards.
 - Reset shall not initiate a restart.
 - Its operating handle shall be colored red with background yellow.

MAIN EMERGENCY ON-OFF SWITCH

- Disconnecting device with function of an emergency stop device.
 - Its operating handle shall be colored red with background yellow.
 - Be provided with a means permitting it to lock in the off position (e.g. by padlocks).

Switch type		ISV16	ISV25	ISV32	ISV50	ISV63	ISV80	ISV100	
Rated insulation voltage V_i	IEC 60 947-3	690	690	690	690	690	690	690	
	UL / CSA 240Vac V	600	-	600	-	(600)	(600)	(600)	
Rated impulse withstand voltage V_{imp}	IEC 60 947-3	kV	6	6	6	6	6	6	
Thermal current I_{the}	IEC 60 947-3		25	32	40	50	63	80	100
	UL / CSA	A	20	-	40	-	(80)	(100)	(100)
Thermal current I_{the}	IEC 60 947-3		16	25	32	50	63	80	80
Rated operational current I_e:									
AC21A Resistive loads, including moderate overloads			20	25	40	50	63	80	100
AC22A Mixed resistive and induct. loads including moderate overloads	IEC 60 947-3	690V A	16	25	32	50	63	80	80
AC23A Switching off motor loads or other highly inductive loads	IEC 60 947-3	3 phases 230V kW	7.5	9	10	11	15	18.5	22
		3 poles 400V kW	13	15	18.5	22	25	30	35
		500V kW	13	15	18.5	22	30	37	45
		690V kW	15	18.5	22	18.5	18.5	22	30
AC3 Squirrel-cage motor: starting, switching off motor during running	IEC 60 947-3	3 phases 230V kW	6	7.5	9	11	11	15	18.5
		3 poles 400V kW	10	13	15	18.5	18.5	22	30
		500V kW	10	13	15	18.5	22	30	37
		690V kW	12	15	18.5	15	15	18.5	22
Standard motor load	UL/CSA	3 phases 120Vac HP	2	(3)	5	-	-	-	-
		240Vac HP	5	(7.5)	10	-	(20)	(25)	(25)
		3 poles 480Vac HP	10	(10)	15	-	(30)	(40)	(50)
		600Vac HP	10	(15)	15	-	(30)	(50)	(50)
		1 phase 120Vac HP	1.5	-	3	-	-	-	-
2 poles 240Vac HP	2	-	5	-	-	-	-		
Rated short-time withstand current I_{sw} (1s)	IEC 60 947-3	A	400	800	800	1500	1500	1500	1500
Short circuit protection:									
Conditional short-circuit current	IEC 60 947-3	kAeff	10	10	10	15	15	15	15
Max. fuse size gG characteristic		500 V A	16	25	32	50	63	80	100
Rated short-circuit making capacity I_{cm}	IEC 60 947-3	A	1500	2000	2000	2000	2000	2500	2500
Rated breaking capacity AC23A (cos ϕ 0,45)	IEC 60 947-3	230V A	184	240	240	376	376	560	560
		400V A	192	264	264	376	376	504	504
Permissible wire cage:									
Clamping gauge	IEC 60 947-1		B6	B6	B6	B9	B9	B9	B9
Flexible wire	mm ²		1.5-10	1.5-10	1.5-10	6-35	6-35	6-35	6-35
	AWG		16-8	16-8	16-8	10-1	10-1	10-1	10-1
Stranded wire	mm ²		1.5-16	1.5-16	1.5-16	10-50	10-50	10-50	10-50
	AWG		16-6	16-6	16-6	8-1	8-1	8-1	8-1
Ambient temperature	storage	C°	- 30 + 70						
	operating	C°	- 25 + 55						
Resistance to climate condition	damp heat, constant IEC 68 part:		2 - 3						
	damp heat, cyclic IEC 68 part:		2 - 30						
Auxiliary contact:			ISV16	ISV25	ISV32	ISV50	ISV63	ISV80	ISV100
Rated insulation voltage V_i	IEC 60 947-3	V	690						
Thermal current I_{th}	IEC 60 947-3	A	20	32	40	12			
Rated operational current I_e:									
AC15 Control of electromagnetic loads	IEC 60 947-5	230V	6						
AC21A Resistive loads, including moderate overloads	IEC 60 947-3	690V A	20	25	40	-			
Approvals									
ISV16	ISV25	ISV32	ISV50	ISV63	ISV80	ISV100			

Type ISV16
Disconnect switches
Rating 16 amps

Flush mounting

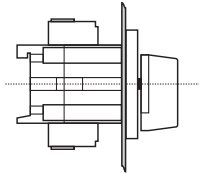

For mounting, see next page.

Base mounting

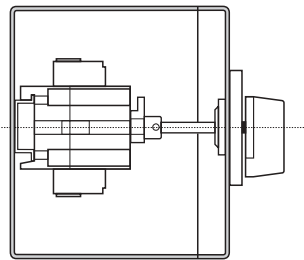

For mounting, see next page.

Contact diagram

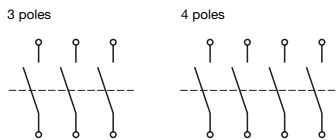

ISV16...E
Rating 16 amps
Flush mounting

Mounting sequence

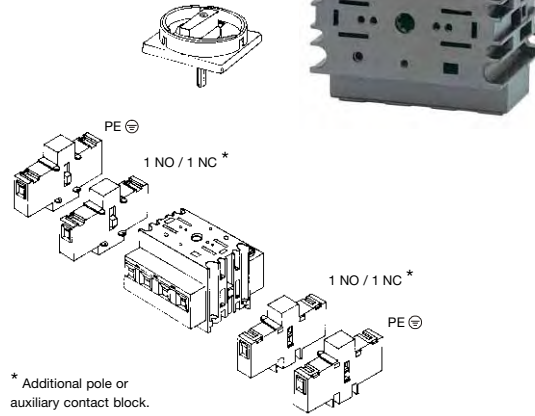

* Additional pole or auxiliary contact block.

Dimensions - Drilling
in mm

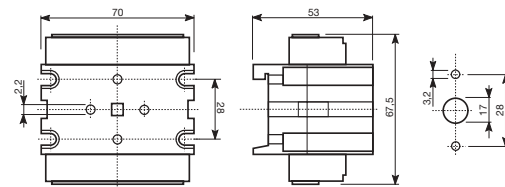

No. of poles	Type	Reference
3	ISV16 3E	RVE0359 001.14
4	ISV16 4E	RVE0359 002.15

ISV16...S
Rating 16 amps
Base mounting

Mounting sequence

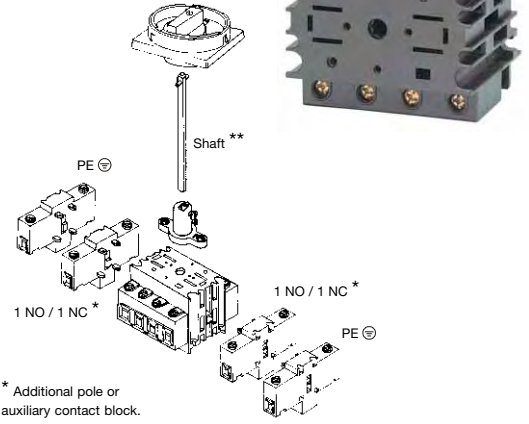

* Additional pole or auxiliary contact block.

Dimensions - Drilling
in mm

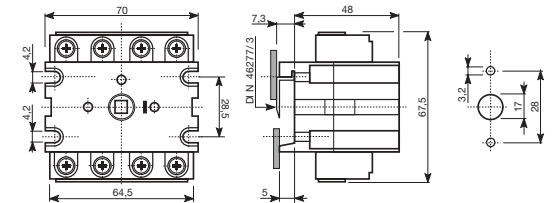

No. of poles	Type	Reference
3	ISV16 3S	RVE0359 013.07
4	ISV16 4S	RVE0359 014.00

** Standard shaft included. See next page.

Characteristics

Rated insulation voltage	Vi	(IEC 60 947-3) 690 (UL/CSA) 600	(IEC 60 947-3) 690 (UL/CSA) 600
Rated impulse withstand voltage	Vimp	(IEC 60 947-3) 6	(IEC 60 947-3) 6
Thermal current	Ith	(IEC 60 947-3) 25 (UL/CSA) 20	(IEC 60 947-3) 25 (UL/CSA) 20
Thermal current	Ithe	(IEC 60 947-3) 16	(IEC 60 947-3) 16
Min. / max. wire size (flexible wire)		1 x 1.5 mm ² or 16 AWG min. / 1 x 10 mm ² or 8 AWG max.	1 x 1.5 mm ² or 16 AWG min. / 1 x 10 mm ² or 8 AWG max.
Min. / max. wire size (stranded wire)		1 x 1.5 mm ² or 16 AWG min. / 1 x 16 mm ² or 6 AWG max.	1 x 1.5 mm ² or 16 AWG min. / 1 x 16 mm ² or 6 AWG max.

On-off switches for disconnect switch ISV16

Type	Reference	Type	Reference	Type	Reference	Type	Reference	Type	Reference	Type	Reference
ISV16...E	FAV 48 NE RVE0359 007.12	FAV 48 RE RVE0359 008.23	FAV 64 NE RVE0359 009.24	FAV 64 RE RVE0359 010.10	FAV C NE RVE0359 011.05	FAV C RE RVE0359 012.06					
ISV16...S	FAV 48 NS RVE0359 023.01	FAV 48 RS RVE0359 024.02	FAV 64 NS RVE0359 025.03	FAV 64 RS RVE0359 026.04	FAV C NS RVE0359 027.05	FAC C RS RVE0359 028.16					



On-off switch with door interlock device, anodized grey plate, black knob.

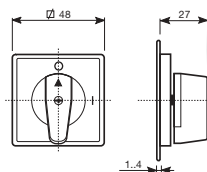

Emergency on-off switch with door interlock device, red knob and yellow plate.



On-off switch with door interlock device, anodized grey plate, black knob.

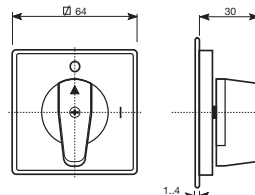

Emergency on-off switch with door interlock device, red knob and yellow plate.



On-off switch with door interlock device, anodized grey plate, black knob.

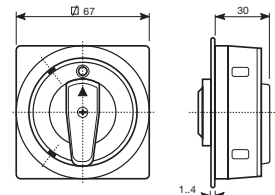

Emergency on-off switch with door interlock device, red knob and yellow plate.

Disconnect switches ISV16 in plastic enclosure

BN

On-off switch with anodized grey plate, black knob mounted in plastic enclosure.

BR

Emergency on-off switch with red knob and yellow plate, mounted in plastic enclosure.



BCR

Main emergency on-off switch with padlock facility in 0 red knob and yellow plate, mounted in plastic enclosure.

BCN

Main on-off switch with padlock facility in 0 black knob and grey plate, mounted in plastic enclosure.

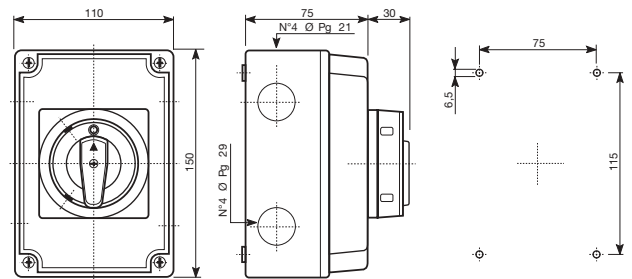
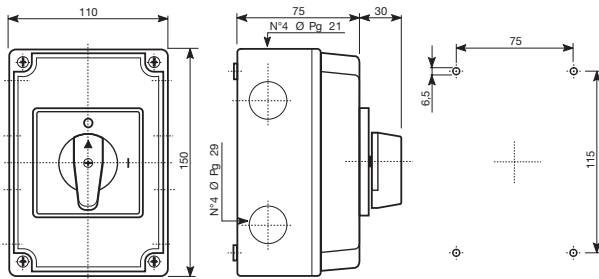

No. of poles	Type	Reference
BN (anodized grey plate and black knob)		
3	ISV16 3BN	RVE0359 029.17
4	ISV16 4BN	RVE0359 033.03
BR (yellow plate and red knob)		
3	ISV16 3BR	RVE0359 030.14
4	ISV16 4BR	RVE0359 034.04

No. of poles	Type	Reference
BCR (yellow plate and red knob)		
3	ISV16 3BCR	RVE0359 032.02
4	ISV16 4BCR	RVE0359 036.06
BCN (grey plate and black knob)		
3	ISV16 3BCN	RVE0359 031.01
4	ISV16 4BCN	RVE0359 035.05

Contact blocks and auxiliary contacts

Additional pole or auxiliary contact block

with double schematic function: if mounted on base mounted body or mounted on flush mounted body.

Type	Reference
1 NO in base mounted body / 1 NC in flush mounted body CAV16 RT	RVE0359 085.00
1 NC in base mounted body / 1 NO in flush mounted body CAV16 TR	RVE0359 088.13
Ground CAV32 P	RVE0359 102.16

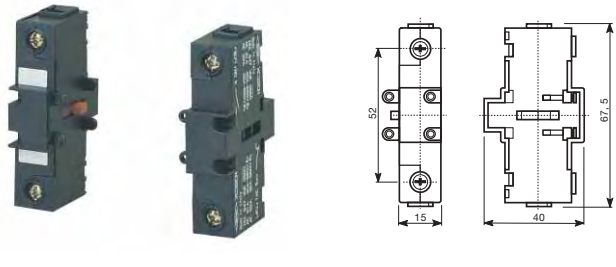

Terminal covers



Type	Reference
CPV32 Q	RVE0359 097.04

Shaft extension



Type	Reference
RAV32	RVE0359 100.20

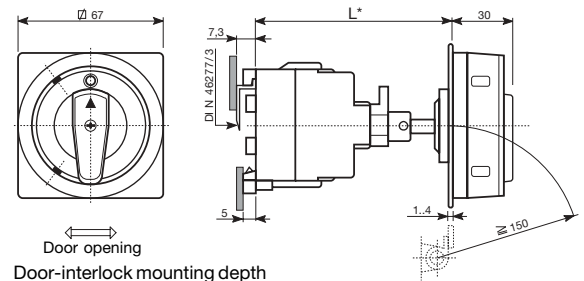

With standard shaft (74 mm)		With shaft extension (175 mm)	
min.	max.	min.	max.
80	110	110	210

* Shaft can be set within the body to match any length in the range shown.

Type ISV25
Disconnect switches
Rating 25 amps

Flush mounting

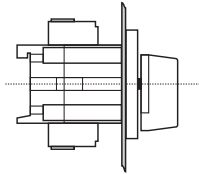

For mounting, see next page.

Base mounting

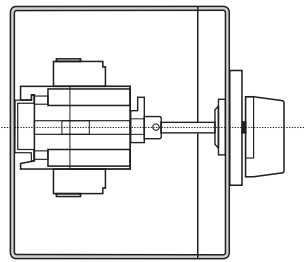

For mounting, see next page.

Contact diagram

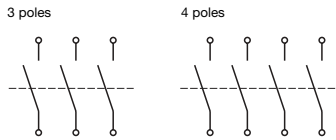

ISV25...E
Rating 25 amps
Flush mounting

Mounting sequence

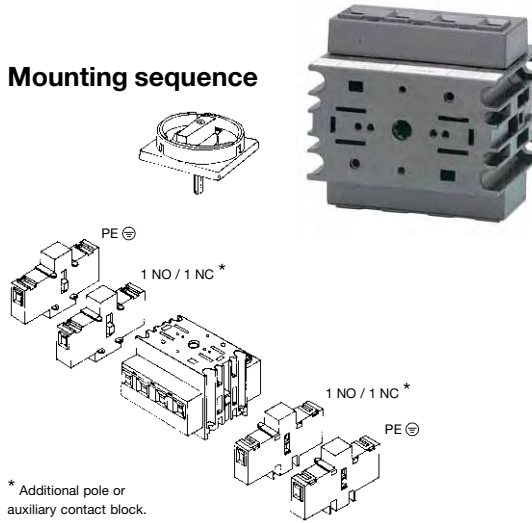

* Additional pole or auxiliary contact block.

Dimensions - Drilling
in mm

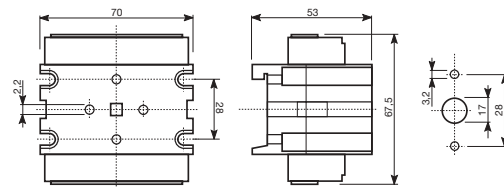

No. of poles	Type	Reference
3	ISV25 3E	RVE0359 003.16
4	ISV25 4E	RVE0359 004.17

ISV25...S
Rating 25 amps
Base mounting

Mounting sequence

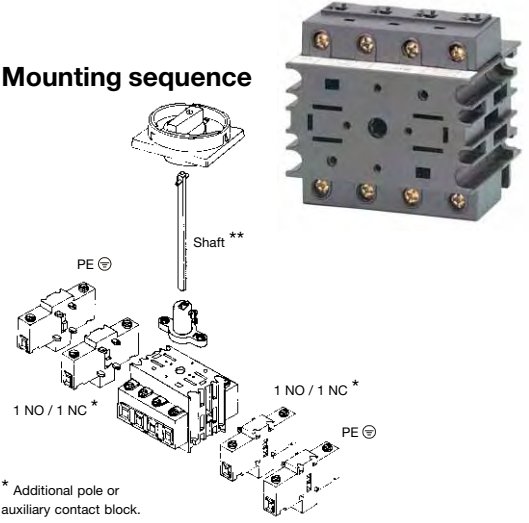

* Additional pole or auxiliary contact block.

Dimensions - Drilling
in mm

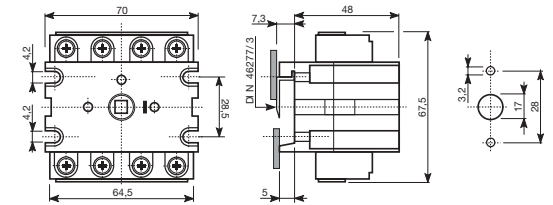

No. of poles	Type	Reference
3	ISV25 3S	RVE0359 015.01
4	ISV25 4S	RVE0359 016.02

** Standard shaft included. See next page.

Characteristics

Rated insulation voltage	Vi	(IEC 60 947-3) 690	(IEC 60 947-3) 690
Rated impulse withstand voltage	Vmp	(IEC 60 947-3) 6	(IEC 60 947-3) 6
Thermal current	Ith	(IEC 60 947-3) 32	(IEC 60 947-3) 32
Thermal current	Ithe	(IEC 60 947-3) 25	(IEC 60 947-3) 25
Min. / max. wire size (flexible wire)		1 x 1.5 mm ² or 16 AWG min. / 1 x 10 mm ² or 8 AWG max.	1 x 1.5 mm ² or 16 AWG min. / 1 x 10 mm ² or 8 AWG max.
Min. / max. wire size (stranded wire)		1 x 1.5 mm ² or 16 AWG min. / 1 x 16 mm ² or 6 AWG max.	1 x 1.5 mm ² or 16 AWG min. / 1 x 16 mm ² or 6 AWG max.

On-off switches for disconnect switch ISV25

Type	Reference	Type	Reference	Type	Reference	Type	Reference	Type	Reference	Type	Reference
------	-----------	------	-----------	------	-----------	------	-----------	------	-----------	------	-----------

ISV25...E	FAV 48 NE	RVE0359 007.12	FAV 48 RE	RVE0359 008.23	FAV 64 NE	RVE0359 009.24	FAV 64 RE	RVE0359 010.10	FAV C NE	RVE0359 011.05	FAV C RE	RVE0359 012.06
ISV25...S	FAV 48 NS	RVE0359 023.01	FAV 48 RS	RVE0359 024.02	FAV 64 NS	RVE0359 025.03	FAV 64 RS	RVE0359 026.04	FAV C NS	RVE0359 027.05	FAV C RS	RVE0359 028.16



On-off switch with door interlock device, anodized grey plate, black knob.

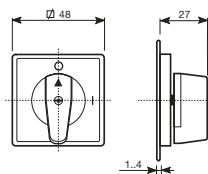

Emergency on-off switch with door interlock device, red knob and yellow plate.



On-off switch with door interlock device, anodized grey plate, black knob.

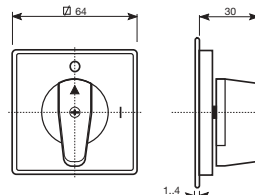

Emergency on-off switch with door interlock device, red knob and yellow plate.



On-off switch with door interlock device, anodized grey plate, black knob.

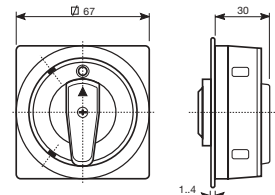

Emergency on-off switch with door interlock device, red knob and yellow plate.

Disconnect switches ISV25 in plastic enclosure

BN

On-off switch with anodized grey plate, black knob mounted in plastic enclosure.

BR

Emergency on-off switch with red knob and yellow plate, mounted in plastic enclosure.

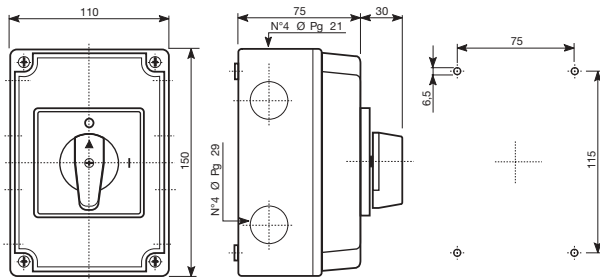

BCR

Main emergency on-off switch with padlock facility in 0 red knob and yellow plate, mounted in plastic enclosure.

BCN

Main on-off switch with padlock facility in 0 black knob and grey plate, mounted in plastic enclosure.

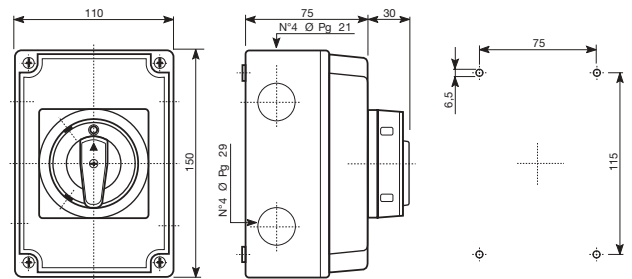

No. of poles	Type	Reference
BN (anodized grey plate and black knob)		
3	ISV25 3BN	RVE0359 037.07
4	ISV25 4BN	RVE0359 041.13
BR (yellow plate and red knob)		
3	ISV25 3BR	RVE0359 038.10
4	ISV25 4BR	RVE0359 042.14

No. of poles	Type	Reference
BCR (yellow plate and red knob)		
3	ISV25 3BCR	RVE0359 040.26
4	ISV25 4BCR	RVE0359 044.16
BCN (grey plate and black knob)		
3	ISV25 3BCN	RVE0359 039.11
4	ISV25 4BCN	RVE0359 043.15

Contact blocks and auxiliary contacts

Additional pole or auxiliary contact block

with double schematic function: if mounted on base mounted body or mounted on flush mounted body.

Type	Reference
1 NO in base mounted body / 1 NC in flush mounted body CAV25 RT	RVE0359 086.01
1 NC in base mounted body / 1NO in flush mounted body CAV25 TR	RVE0359 089.14
Ground CAV32 P	RVE0359 102.16

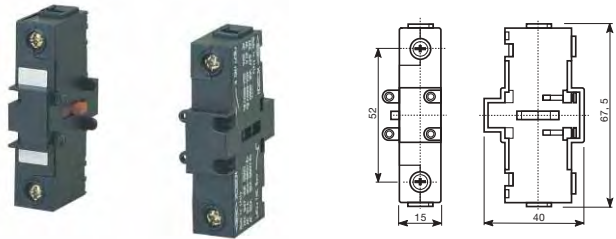
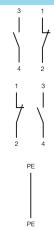

Terminal covers



Type	Reference
CPV32 Q	RVE0359 097.04

Shaft extension



Type	Reference
RAV32	RVE0359 100.20

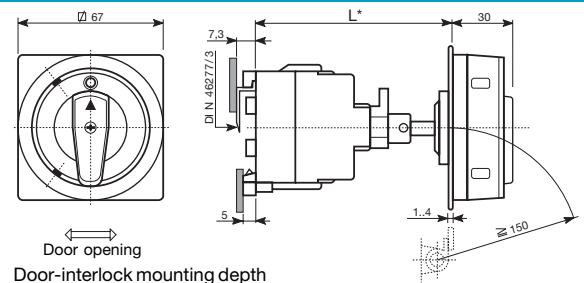

With standard shaft (74 mm)		With shaft extension (175 mm)	
min.	max.	min.	max.
80	110	110	210

* Shaft can be set within the body to match any length in the range shown.

Type ISV32
Disconnect switches
Rating 32 amps

Flush mounting

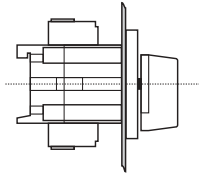

For mounting, see next page.

Base mounting

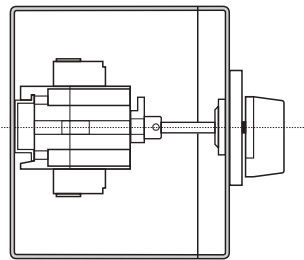

For mounting, see next page.

Contact diagram

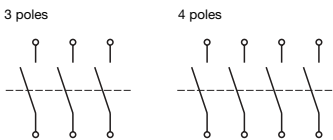

ISV32...E
Rating 32 amps
Flush mounting

Mounting sequence

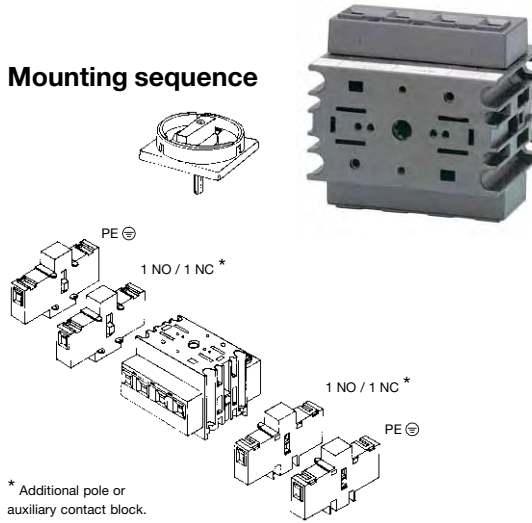

* Additional pole or auxiliary contact block.

Dimensions - Drilling
in mm

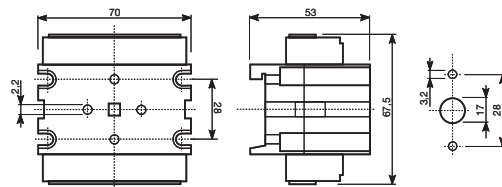

No. of poles	Type	Reference
3	ISV32 3E	RVE0359 005.10
4	ISV32 4E	RVE0359 006.11

ISV32...S
Rating 32 amps
Base mounting

Mounting sequence

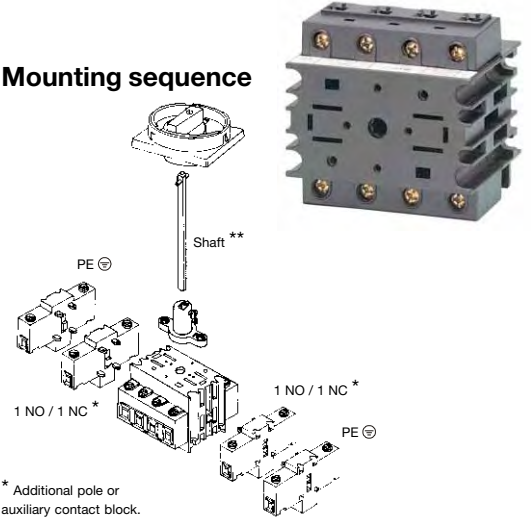

* Additional pole or auxiliary contact block.

Dimensions - Drilling
in mm

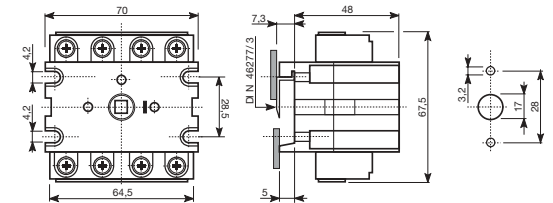

No. of poles	Type	Reference
3	ISV32 3S	RVE0359 017.03
4	ISV32 4S	RVE0359 018.14

** Standard shaft included. See next page.

Characteristics

Rated insulation voltage	Vi	(IEC 60 947-3) 690 (UL/CSA) 600	(IEC 60 947-3) 690 (UL/CSA) 600
Rated impulse withstand voltage	Vimp	(IEC 60 947-3) 6	(IEC 60 947-3) 6
Thermal current	Ith	(IEC 60 947-3) 40 (UL/CSA) 40	(IEC 60 947-3) 40 (UL/CSA) 40
Thermal current	Ithe	(IEC 60 947-3) 32	(IEC 60 947-3) 32
Min. / max. wire size (flexible wire)		1 x 1.5 mm ² or 16 AWG min. / 1 x 10 mm ² or 8 AWG max.	1 x 1.5 mm ² or 16 AWG min. / 1 x 10 mm ² or 8 AWG max.
Min. / max. wire size (stranded wire)		1 x 1.5 mm ² or 16 AWG min. / 1 x 16 mm ² or 6 AWG max.	1 x 1.5 mm ² or 16 AWG min. / 1 x 16 mm ² or 6 AWG max.

On-off switches for disconnect switch ISV32

Type	Reference	Type	Reference	Type	Reference	Type	Reference	Type	Reference	Type	Reference
ISV32...E	FAV 48 NE RVE0359 007.12	FAV 48 RE RVE0359 008.23	FAV 64 NE RVE0359 009.24	FAV 64 RE RVE0359 010.10	FAV C NE RVE0359 011.05	FAV C RE RVE0359 012.06					
ISV32...S	FAV 48 NS RVE0359 023.01	FAV 48 RS RVE0359 024.02	FAV 64 NS RVE0359 025.03	FAV 64 RS RVE0359 026.04	FAV C NS RVE0359 027.05	FAC C RS RVE0359 028.16					



On-off switch with door interlock device, anodized grey plate, black knob.

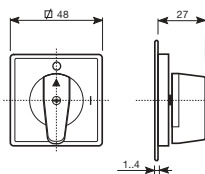

Emergency on-off switch with door interlock device, red knob and yellow plate.



On-off switch with door interlock device, anodized grey plate, black knob.

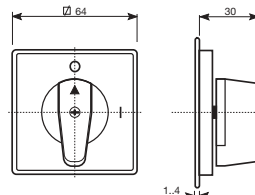

Emergency on-off switch with door interlock device, red knob and yellow plate.



On-off switch with door interlock device, anodized grey plate, black knob.

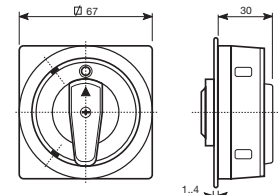

Emergency on-off switch with door interlock device, red knob and yellow plate.

Disconnect switches ISV32 in plastic enclosure

BN

On-off switch with anodized grey plate, black knob mounted in plastic enclosure.

BR

Emergency on-off switch with red knob and yellow plate, mounted in plastic enclosure.

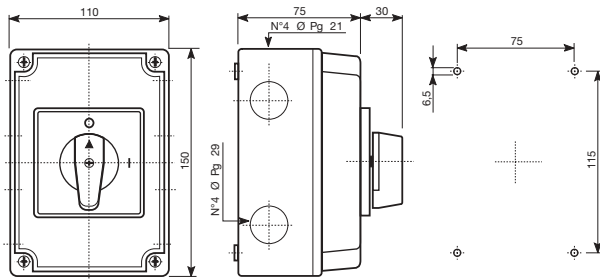

BCR

Main emergency on-off switch with padlock facility in 0 red knob and yellow plate, mounted in plastic enclosure.

BCN

Main on-off switch with padlock facility in 0 black knob and grey plate, mounted in plastic enclosure.

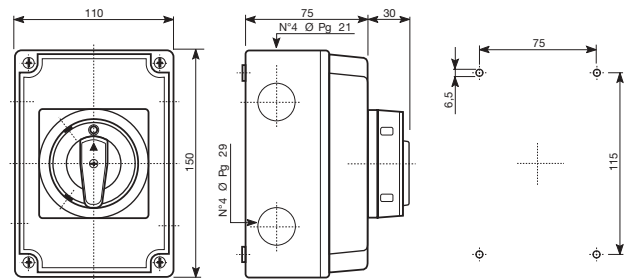

No. of poles	Type	Reference
BN (anodized grey plate and black knob)		
3	ISV32 3BN	RVE0359 045.17
4	ISV32 4BN	RVE0359 049.23
BR (yellow plate and red knob)		
3	ISV32 3BR	RVE0359 046.10
4	ISV32 4BR	RVE0359 050.20

No. of poles	Type	Reference
BCR (yellow plate and red knob)		
3	ISV32 3BCR	RVE0359 048.22
4	ISV32 4BCR	RVE0359 052.16
BCN (grey plate and black knob)		
3	ISV32 3BCN	RVE0359 047.11
4	ISV32 4BCN	RVE0359 051.15

Contact blocks and auxiliary contacts

Additional pole or auxiliary contact block

with double schematic function: if mounted on base mounted body or mounted on flush mounted body.

Type	Reference
1 NO in base mounted body / 1 NC in flush mounted body CAV32 RT	RVE0359 087.02
1 NC in base mounted body / 1 NO in flush mounted body CAV32 TR	RVE0359 090.11
Ground CAV32 P	RVE0359 102.16

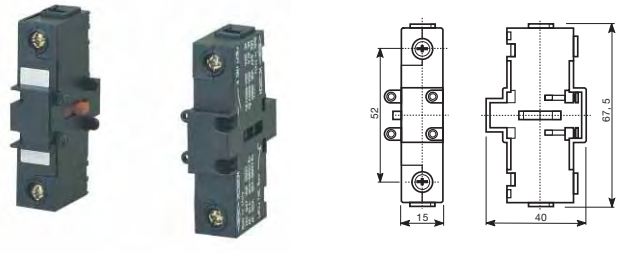

Terminal covers



Type	Reference
CPV32 Q	RVE0359 097.04

Shaft extension



Type	Reference
RAV32	RVE0359 100.20

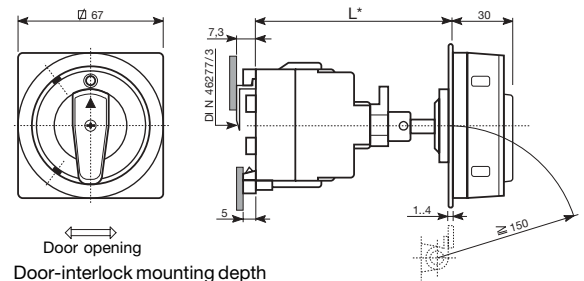

With standard shaft (74 mm)		With shaft extension (175 mm)	
min.	max.	min.	max.
80	110	110	210

* Shaft can be set within the body to match any length in the range shown.

Type ISV50 and ISV63
Disconnect switches
 Rating 50 amps and 63 amps

ISV50...S
 Rating 50 amps
 Base mounting

ISV63...S
 Rating 63 amps
 Base mounting



Base mounting

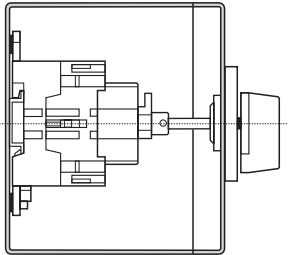

For mounting, see next page.

Mounting sequence

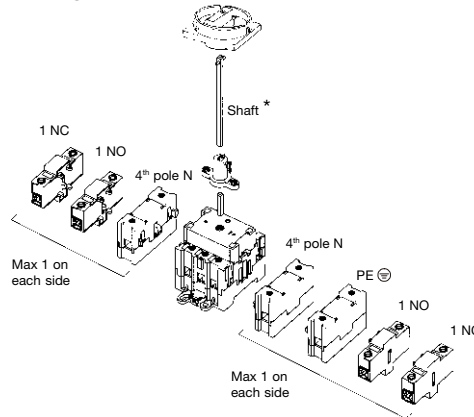

* Standard shaft included. See next page.

Dimensions - Drilling

in mm

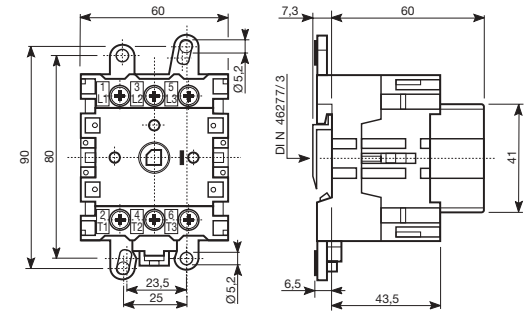

Contact diagram

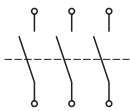

No. of poles	Type	Reference	No. of poles	Type	Reference
3	ISV50 3S	RVE0359 019.15	3	ISV63 3S	RVE0359 020.12

Characteristic	ISV50...S	ISV63...S
Rated insulation voltage V_i	(IEC 60 947-3) 690	(IEC 60 947-3) 690
Rated impulse withstand voltage V_{imp}	(IEC 60 947-3) 6	(IEC 60 947-3) 6
Thermal current I_{th}	(IEC 60 947-3) 50	(IEC 60 947-3) 63
Thermal current I_{the}	(IEC 60 947-3) 50	(IEC 60 947-3) 63
Min. / max. wire size (flexible wire)	1 x 6 mm ² or 10 AWG min. / 1 x 35 mm ² or 1 AWG max.	1 x 6 mm ² or 10 AWG min. / 1 x 35 mm ² or 1 AWG max.
Min. / max. wire size (stranded wire)	1 x 10 mm ² or 8 AWG min. / 1 x 50 mm ² or 1 AWG max.	1 x 10 mm ² or 8 AWG min. / 1 x 50 mm ² or 1 AWG max.

On-off switches for disconnect switch ISV50 and ISV63

Type	Reference	Type	Reference	Type	Reference	Type	Reference
ISV16...E FAV 64 NS	RVE0359 025.03	FAV 64 RS	RVE0359 026.04	FAV C NS	RVE0359 027.05	FAC C RS	RVE0359 028.16
ISV16...S FAV 64 NS	RVE0359 025.03	FAV 64 RS	RVE0359 026.04	FAV C NS	RVE0359 027.05	FAC C RS	RVE0359 028.16



On-off switch with door interlock device, anodized grey plate, black knob.



Emergency on-off switch with door interlock device, red knob and yellow plate.



On-off switch with door interlock device, anodized grey plate, black knob.



Emergency on-off switch with door interlock device, red knob and yellow plate.

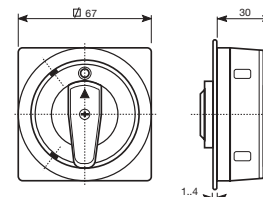
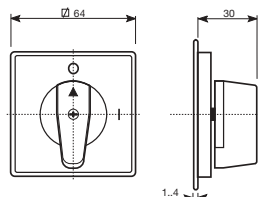

Disconnect switches ISV50 and ISV63 in plastic enclosure

BN
On-off switch with anodized grey plate, black knob mounted in plastic enclosure.

BR
Emergency on-off switch with red knob and yellow plate, mounted in plastic enclosure.

BCR
Main emergency on-off switch with padlock facility in 0 red knob and yellow plate, mounted in plastic enclosure.

BCN
Main on-off switch with padlock facility in 0 black knob and grey plate, mounted in plastic enclosure.

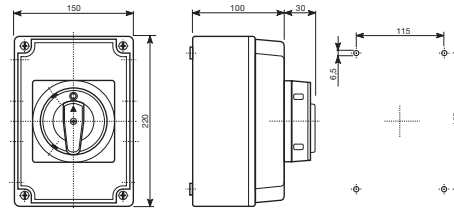
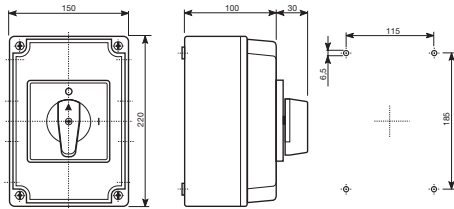

ISV50

ISV63

No. of poles	Type	Reference
BN (anodized grey plate and black knob)		
3	ISV50 3BN	RVE0359 053.17
4	ISV50 4BN	RVE0359 057.13
BR (yellow plate and red knob)		
3	ISV50 3BR	RVE0359 054.10
4	ISV50 4BR	RVE0359 058.24
BCR (yellow plate and red knob)		
3	ISV50 3BCR	RVE0359 056.12
4	ISV50 4BCR	RVE0359 060.22
BCN (grey plate and black knob)		
3	ISV50 3BCN	RVE0359 055.11
4	ISV50 4BCN	RVE0359 059.25

No. of poles	Type	Reference
BN (anodized grey plate and black knob)		
3	ISV63 3BN	RVE0359 061.17
4	ISV63 4BN	RVE0359 065.13
BR (yellow plate and red knob)		
3	ISV63 3BR	RVE0359 062.10
4	ISV63 4BR	RVE0359 066.14
BCR (yellow plate and red knob)		
3	ISV63 3BCR	RVE0359 064.12
4	ISV63 4BCR	RVE0359 068.26
BCN (grey plate and black knob)		
3	ISV63 3BCN	RVE0359 063.11
4	ISV63 4BCN	RVE0359 067.15

Contact blocks and auxiliary contacts for ISV50 and ISV63

Auxiliary contact block

Type	Reference
1 NO in base mounted body CAV100 R	RVE0359 092.07
1 NC in base mounted body CAV100 T	RVE0359 091.06
Ground CAV100 P	RVE0359 103.17



Auxiliary contact

Additional pole

Additional pole for ISV50

Additional pole for ISV63

Type	Reference	Type	Reference
4 th pole CAV50 Q	RVE0359 093.00	4 th pole CAV63 Q	RVE0359 094.01

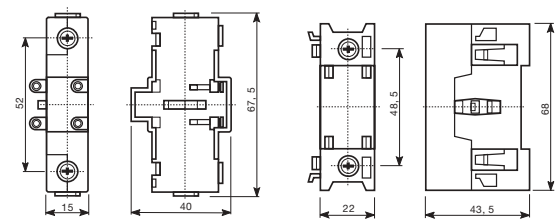

Terminal covers



CPV100 U

CPV100 T

For auxiliary contact or additional pole

Shaft extension

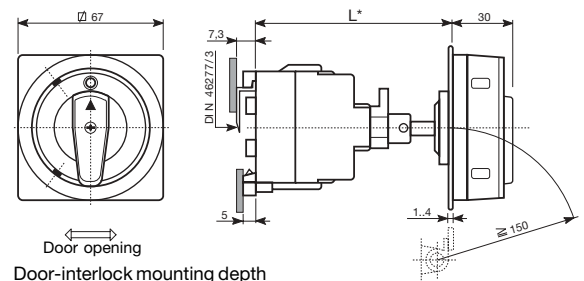

With standard shaft (80 mm)		With shaft extension (160 mm)	
min.	max.	min.	max.
100	152	100	232

* To be cut to match any length within the range shown.

Type ISV80 and ISV100
Disconnect switches
 Rating 80 amps and 100 amps

ISV80...S
 Rating 80 amps
 Base mounting

ISV100...S
 Rating 100 amps
 Base mounting



Base mounting

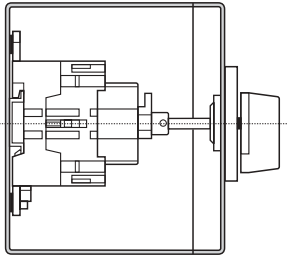

For mounting, see next page.

Mounting sequence

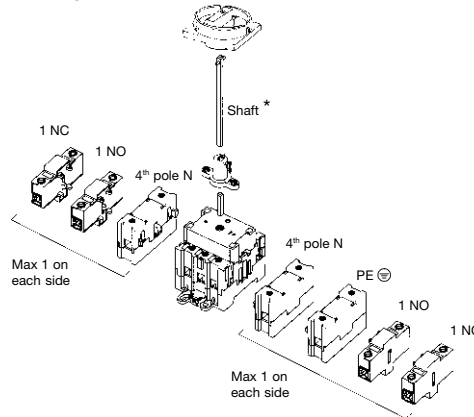

* Standard shaft included. See next page

Dimensions - Drilling

in mm

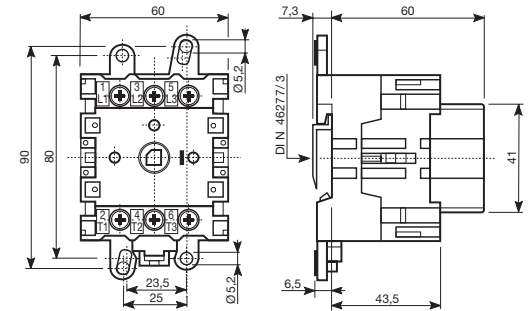

Contact diagram

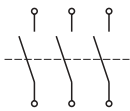

No. of poles	Type	Reference	No. of poles	Type	Reference
3	ISV80 3S	RVE0359 021.07	3	ISV100 3S	RVE0359 022.00

Characteristic	ISV80...S	ISV100...S
Rated insulation voltage V_i	(IEC 60 947-3) 690	(IEC 60 947-3) 690
Rated impulse withstand voltage V_{imp}	(IEC 60 947-3) 6	(IEC 60 947-3) 6
Thermal current I_{th}	(IEC 60 947-3) 80	(IEC 60 947-3) 100
Thermal current I_{the}	(IEC 60 947-3) 80	(IEC 60 947-3) 80
Min. / max. wire size (flexible wire)	1 x 6 mm ² or 10 AWG min. / 1 x 35 mm ² or 1 AWG max.	1 x 6 mm ² or 10 AWG min. / 1 x 35 mm ² or 1 AWG max.
Min. / max. wire size (stranded wire)	1 x 10 mm ² or 8 AWG min. / 1 x 50 mm ² or 1 AWG max.	1 x 10 mm ² or 8 AWG min. / 1 x 50 mm ² or 1 AWG max.

On-off switches for disconnect switch ISV80 and ISV100

Type	Reference	Type	Reference	Type	Reference	Type	Reference
ISV80...S	FAV 64 NS RVE0359 025.03	FAV 64 RS RVE0359 026.04	FAV C NS RVE0359 027.05	FAC C RS RVE0359 028.16			
ISV100...S	FAV 64 NS RVE0359 025.03	FAV 64 RS RVE0359 026.04	FAV C NS RVE0359 027.05	FAC C RS RVE0359 028.16			



On-off switch with door interlock device, anodized grey plate, black knob.



Emergency on-off switch with door interlock device, red knob and yellow plate.



On-off switch with door interlock device, anodized grey plate, black knob.



Emergency on-off switch with door interlock device, red knob and yellow plate.

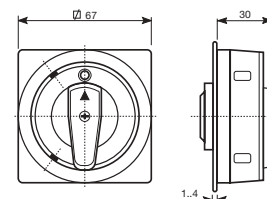
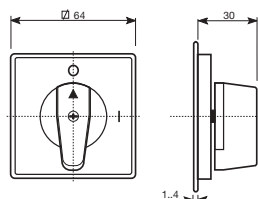

Disconnect switches ISV80 and ISV100 in plastic enclosure

BN
On-off switch with anodized grey plate, black knob mounted in plastic enclosure.

BR
Emergency on-off switch with red knob and yellow plate, mounted in plastic enclosure.

BCR
Main emergency on-off switch with padlock facility in 0 red knob and yellow plate, mounted in plastic enclosure.

BCN
Main on-off switch with padlock facility in 0 black knob and grey plate, mounted in plastic enclosure.

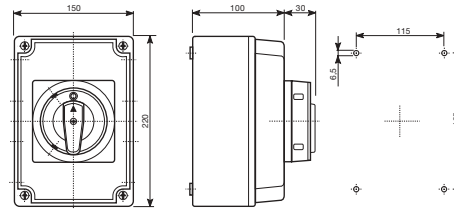
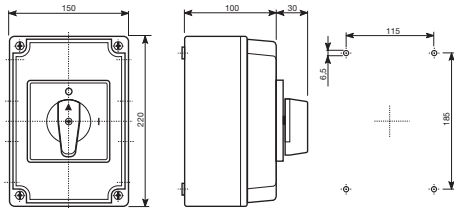

ISV80

ISV100

No. of poles	Type	Reference
BN (anodized grey plate and black knob)		
3	ISV80 3BN	RVE0359 069.27
4	ISV80 4BN	RVE0359 073.13
BR (yellow plate and red knob)		
3	ISV80 3BR	RVE0359 070.24
4	ISV80 4BR	RVE0359 074.14
BCR (yellow plate and red knob)		
3	ISV80 3BCR	RVE0359 072.12
4	ISV80 4BCR	RVE0359 076.16
BCN (grey plate and black knob)		
3	ISV80 3BCN	RVE0359 071.11
4	ISV80 4BCN	RVE0359 075.15

No. of poles	Type	Reference
BN (anodized grey plate and black knob)		
3	ISV100 3BN	RVE0359 077.17
4	ISV100 4BN	RVE0359 081.04
BR (yellow plate and red knob)		
3	ISV100 3BR	RVE0359 078.20
4	ISV100 4BR	RVE0359 082.05
BCR (yellow plate and red knob)		
3	ISV100 3BCR	RVE0359 080.17
4	ISV100 4BCR	RVE0359 084.07
BCN (grey plate and black knob)		
3	ISV100 3BCN	RVE0359 079.21
4	ISV100 4BCN	RVE0359 083.06

Contact blocks and auxiliary contacts for ISV80 and ISV100

Auxiliary contact block

Type	Reference
1 NO in base mounted body CAV100 R	RVE0359 092.07
1 NC in base mounted body CAV100 T	RVE0359 091.06
Ground CAV100 P	RVE0359 103.17



Auxiliary contact

Additional pole

Additional pole for ISV80

Additional pole for ISV100

Type	Reference	Type	Reference
4 th pole CAV80 Q	RVE0359 095.02	4 th pole CAV100 Q	RVE0359 096.03

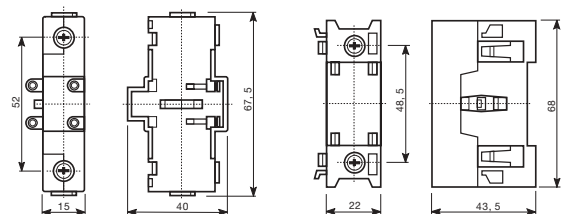

Terminal covers

Shaft extension



CPV100 U

CPV100 T

For auxiliary contact or additional pole



Type	Reference
RAV100	RVE0359 101.15

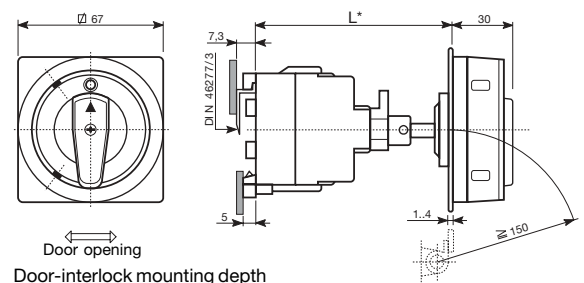

With standard shaft (80 mm)		With shaft extension (160 mm)	
min.	max.	min.	max.
100	152	100	232

* To be cut to match any length within the range shown.