



1075T/65T SERIES TERMINAL MAGNETIC CONTACTS

**3/8" DIA.
Press Fit**

Model numbers:
1065T, 1065TW, 1075T, 1075TW

- **New terminal design for easy connection**
- **Press fit design for quick installation**
- **Wide gap available, for reduced false alarms on loose-fitting windows and doors**

Sentrol's 1075T/65T Press Fit Terminal Switch is a 3/8" DIA. magnetic contact with terminal connection. Use no glue or screws to mount; small ribs on the housing hold the contact in place. Heavy-duty housing resists crushing from swelling wood. An extra-wide gap version is available in the 1065 Series for applications that may be prone to false alarms caused by loose fitting doors. Use indoors or outdoors for an attractive recessed installation.

The terminal connection adds to the ease of installation. Simply strip the wire, insert it into the terminal block and tighten. The terminal accepts any wire size from 14 to 22 gauge, and has a unique one piece design for added strength.

Sentrol 1075T/65T Series 3/8" DIA. Press Fit Terminal Contacts

Applications

For recessed applications, either indoor or outdoor. Wide gap distances help prevent false alarms caused by loose-fitting doors. Also useful in protecting china cabinets or closets, double-hung windows, and aluminum windows.

Architects and Engineering Specifications

The 1075T/65T Series terminal contact measures 3/8" DIA. (0.95 cm). The contact and magnet housings are made of flame-retardant ABS plastic. The housings have three ribs that press fit against the inside of a 3/8" DIA. mounting hole. The reed switch is fully encapsulated in Sentrol's exclusive polyurethane potting material.

Specifications:

Form A (1065T, 1065TW, 1075T, 1075TW)

Voltage 100 V AC/DC max
 Current 0.5 A max
 Power 7.5 W max

1075T, 1075TW

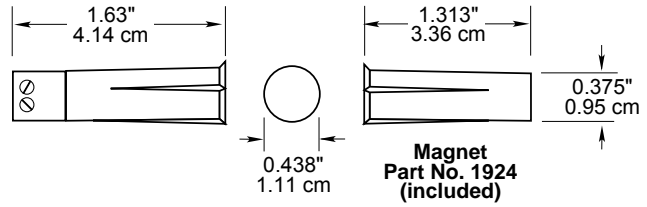

1065T, 1065TW

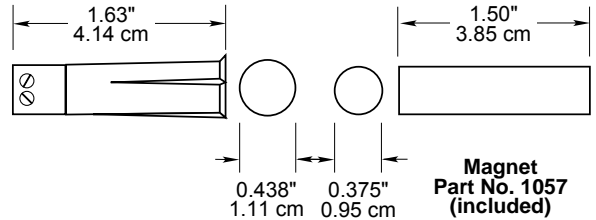

Ordering Information

Model Number	Hole Required		Loop Type	Gap Configuration	Distance*
	Contact	Magnet			
1065T	0.375" x 1.63"	0.375" x 1.50"	Closed	N.O.	7/8"
1065TW	0.375" x 1.63"	0.375" x 1.50"	Closed	N.O.	2"
1075T	0.375" x 1.63"	0.375" x 1.313"	Closed	N.O.	1/2"
1075TW	0.375" x 1.63"	0.375" x 1.313"	Closed	N.O.	1-1/4"

NOTE:

* Gap Distances are nominal make distance \pm 20%.
 Gap Specifications are for switch to make.
 Break Distance is approximately 1.1 to 1.5 times make.



SECURITY & LIFE SAFETY GROUP

CADDX | ESL | GBC | ITI | SENTROL