



# SENTROL

## 1045 Series Industrial Surface Mount with Wire Leads Magnetic Contacts

Gap distance	Closed loop	SPDT
Regular 1 1/4"	1045	
Wide 3"	1045W	
3/8" Min. 1 1/4" Max.		1047H

Color	Natural	Mahogany brown	Grey
Quantity	5	10	



1045-N



**100% TESTED**



0 4618801243 5

## 1045 Series Industrial Surface Mount with Wire Leads Magnetic Contacts

### Installation Instructions

#### 1045, 1045W

Select desired mounting positions for contact and magnet. Align labels on contact and magnet so labels read in the same direction.

#### 1047H

Mount contact in desired location. Attach ohmmeter to "Closed Loop" and "Common" terminals. Meter should read INFINITY with magnet away from contact. Align labels on contact and magnet so labels read in the same direction (switch is polarity sensitive). Bring magnet toward contact until meter reads 0 ohms. Mark this point and continue bringing magnet toward contact until meter again reads INFINITY. Mark this point and position the magnet between these two marks. With magnet positioned correctly, the contact shall have a balanced operation and will be more difficult to defeat if an external magnet is used in such an attempt.

#### Lead colors on SPDT

Black: Common  
White: Closed (N.O.)  
Red: Open Loop (N.C.)

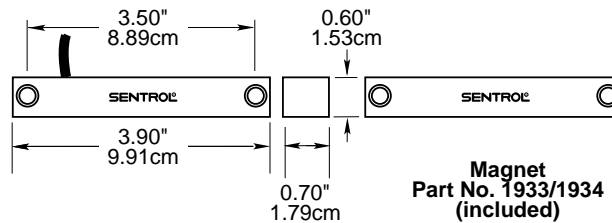

### UL Specifications

\*\*European Union Specifications: 48 VAC/DC Max., 0.5 Amp

Part Number	Loop Type	Electrical Configuration	Gap Distance Make*
1045	Closed	N.O.	1 1/4"
1045W	Closed	N.O.	3"
1047H	Open or Closed	SPDT	3/8" Min. 1 1/4" Max.

**\*\*FORM A (1045, 1045W)**  
Voltage: 100 VAC/DC Max  
Current: 0.5 A Max  
Power: 7.5 W Max

**\*\*FORM C (1047H)**  
Voltage: 30 VAC/DC Max  
Current: 0.25 A Max  
Power: 3.0 W Max

\* Gap Specifications are nominal and may vary  $\pm 20\%$  due to temperature. Gap Specifications are for switch to make. Break distance is approximately 1.1 to 1.5 times make.

**interlogix**  
SECURITY & LIFE SAFETY GROUP

PK-0995 Rev E 11/01