



# Patented Non-Contact Safety Interlock Switch

## 251 F7 GuardSwitch

### Applications

- Requiring a “Fail-Safe” Switch
- Waste Compactors
- Mixers, Blenders and Dryers
- Packaging Machinery
- Food Products Machinery

### General Specifications

Enclosure	Polyurethane Enamel-Coated Aluminum
Temperature Range	-40°F to 150°F (-40°C to 65°C)
Environmental	Hermetically Sealed Contact Switch Encapsulated in Polyurethane
NEMA Rating	1, 2, 3, 4, 4X, 5, 6, 12, 12K
Protection Class	IP 67
Response Time	5 msec
Life Cycles	100,000 Under Full Load; Up to 200,000,000 Under Dry Circuit
Lead Types/O.D.	SJTOW-A (K) 18/3 AWG / 0.33" (0.84cm)
UL/CSA	All Models

*Note: The F7 model has a patented “watch-dog” circuit which, when switch failure occurs, the fused watch-dog circuit will draw 4.0 Amps. The voltage supply must have a current capacity of 4.0 Amps. This results in an open, fail-safe condition.*

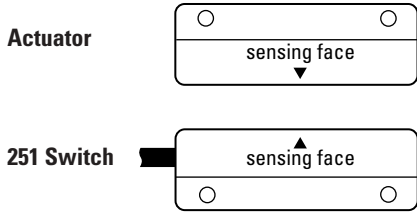
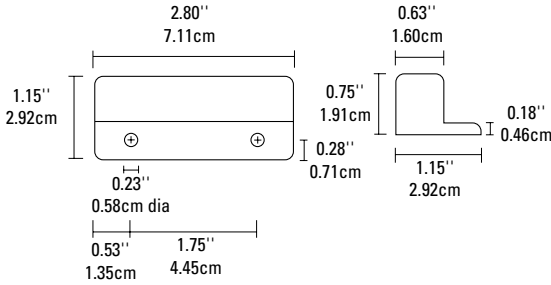

Order Information		Electrical Specifications							
Part Number	Contact <sup>1</sup> Configuration	Load Rating (AC/DC)	Voltage Range (AC/DC)	Switch Current Max. (AC/DC)	Contact Resistance	Sense Range <sup>2</sup> Nominal	Break Range Nominal	Break at Failure Max.	Lead Length
251-F7Z-12K	N.O.	100VA	100-120V AC	0.83A	0.5 Ohms	1.0" (2.5cm)	1.8" (4.5cm)	2.7" (6.8cm)	12' (3.6m)
150-Z	Actuator Only								

**Warning— Each electrical rating is an individual maximum and cannot be exceeded!**

- <sup>1</sup> Configuration with actuator away from the switch
- <sup>2</sup> Proximity of ferrous materials usually reduces sense range — typically by 50%. The shape and type of material cause a wide diversity of effects. Testing is required to determine actual sense range for specific applications.