

1422 Series 304 Stainless Steel Two Door Floor Mount - NEMA 4X

Continuous Hinge



**Inner
Panel
Included**



Corrosion Resistant Floormount Enclosures

Application

- Designed to house electrical, electronic, hydraulic or pneumatic controls and instruments.
- Provides protection where equipment may be hosed down or otherwise be very wet, or in specific applications where corrosion is a serious problem.

Standards

- UL 508 Type 3R, 4, 4X, and 12
- CSA Type 3R, 4, 4X, and 12
- **Complies with**
 - NEMA Type 3R, 4, 4X, 12 and 13
 - JIC EGP-1-1967
 - IEC 60529, IP66

Construction

- Formed 12 gauge 304 stainless steel.
- Smooth, continuously welded seams without knockouts, cutouts or holes.
- Body stiffeners are provided in the larger enclosures for extra rigidity.
- Heavy duty nickel plate/chrome coated lifting eyebolts are provided with reinforcing support angles.
- Center post is removable for easy installation of the inner panel.
- Formed lip on door and top of enclosure opening exclude flowing liquids and contaminants.
- Continuously hinged doors may be removed by pulling the stainless steel hinge pin.
- Doors are secured with heavy duty stainless steel clamps.
- Provision for padlocking.
- 12" floor stands are welded to the enclosure.
- Oil resistant gaskets are permanently secured.
- Panel supports are provided for easy panel installation.
- Collar studs are provided for mounting inner panels.
- A bonding stud is provided on the door and a grounding stud is provided in the enclosure for each door.
- A literature pocket is provided.

Finish

- Cover and enclosure are natural stainless steel with a smooth brushed finish.
- Removable inner panel is finished in white powder coating.

Accessories

- Breather kits...*see page 423*
- Door clamping hardware
...*see page 427*
- Door stop kits...*see page 447*
- Drip shield kits...*see page 447*
- Louvered ventilating plates
...*see page 450*
- Quick release clamp...*see page 427*
- Thermostats...*see page 421-422*
- Window kits...*see page 444*

1422 Series 304 Stainless Steel Two Door Floor Mount - NEMA 4X Continuous Hinge

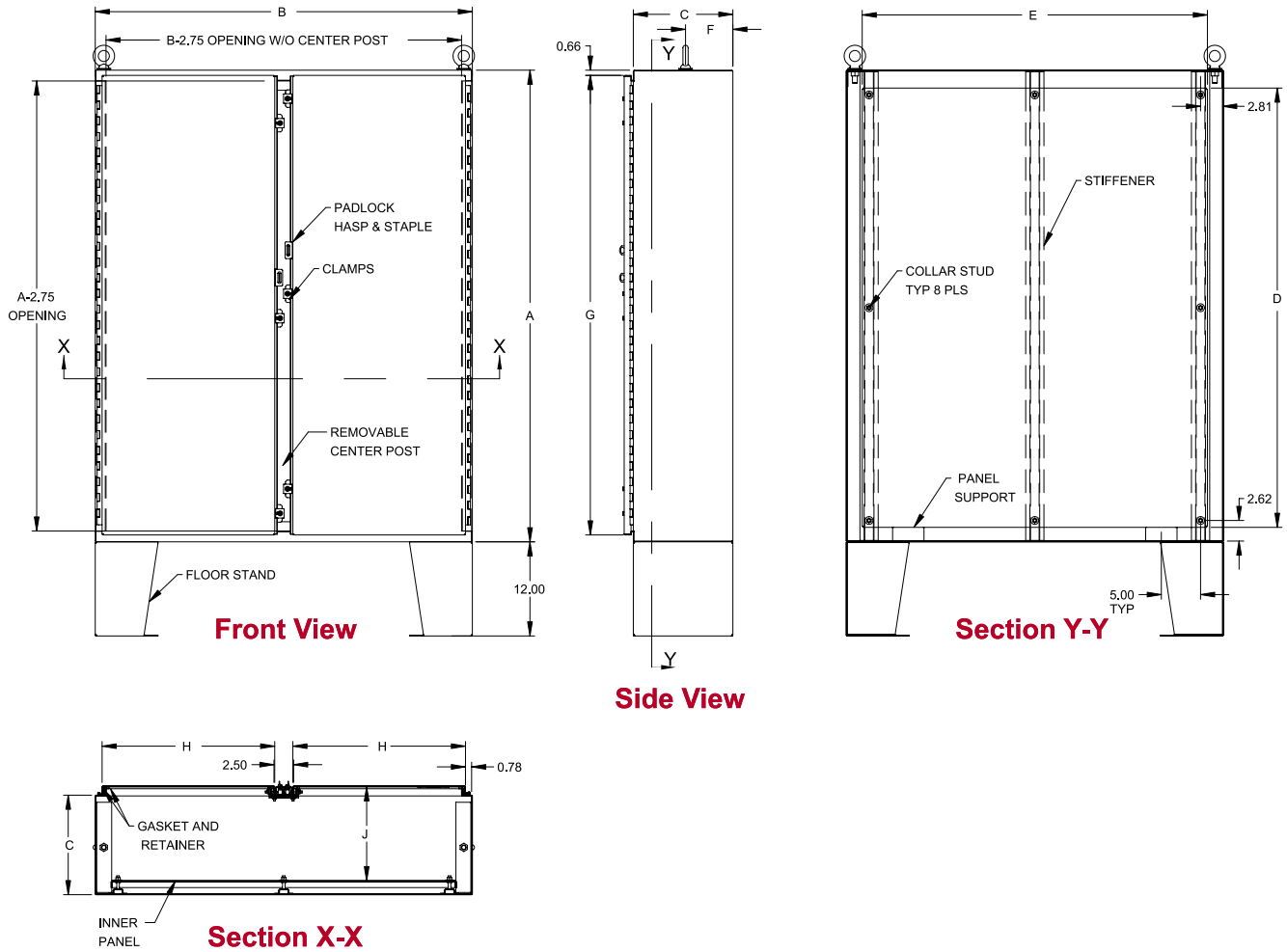

Corrosion Resistant Floormount Enclosures

Part No.	A	B	C	Body Gauge	Panel Gauge	Panel Size		D	E	F	G	H	J	Ship Wt. lbs.
1422N4SSB12F	60.13	48.06	12.69	12	10	56	44	6.3	58.59	22	11.87	491		
1422N4SSD12F	60.13	60.06	12.69	12	10	56	56	6.3	58.59	28	11.87	567		
1422N4SSE12F	72.13	60.06	12.69	12	10	68	56	6.3	70.59	28	11.87	645		
1422N4SSF12F	72.13	72.06	12.69	12	10	68	68	6.3	70.59	34	11.87	750		
1422N4SSF24F	72.13	72.06	24.69	12	10	68	68	12.3	70.59	34	23.87	945		

1422 Series 316 Stainless Steel Two Door Floor Mount - NEMA 4X

Continuous Hinge



**Inner
Panel
Included**



Corrosion Resistant
Floormount Enclosures

Application

- Designed to house electrical, electronic, hydraulic or pneumatic controls and instruments.
- Provides protection where equipment may be hosed down or otherwise be very wet, or in specific applications where corrosion is a serious problem.

Standards

- UL 508 Type 3R, 4, 4X, and 12
- CSA Type 3R, 4, 4X, and 12
- **Complies with**
 - NEMA Type 3R, 4, 4X, 12 and 13
 - JIC EGP-1-1967
 - IEC 60529, IP66

Construction

- Formed 12 gauge 316 stainless steel.
- Smooth, continuously welded seams without knockouts, cutouts or holes.
- Body stiffeners are provided in the larger enclosures for extra rigidity.
- Heavy duty nickel plate/chrome coated lifting eyebolts are provided with reinforcing support angles.
- Center post is removable for easy installation of the inner panel.
- Formed lip on door and top of enclosure opening exclude flowing liquids and contaminants.
- Continuously hinged doors may be removed by pulling the stainless steel hinge pin.
- Doors are secured with heavy duty stainless steel clamps.
- Provision for padlocking.
- 12" floor stands are welded to the enclosure.
- Oil resistant gaskets are permanently secured.
- Panel supports are provided for easy panel installation.
- Collar studs are provided for mounting inner panels.
- A bonding stud is provided on the door and a grounding stud is provided in the enclosure for each door.
- A literature pocket is provided.

Finish

- Cover and enclosure are natural stainless steel with a smooth brushed finish.
- Removable inner panel is finished in white powder coating.

Accessories

- Breather kits...*see page 423*
- Door clamping hardware
...*see page 427*
- Door stop kits...*see page 447*
- Drip shield kits...*see page 447*
- Enclosure stabilizers...*see page 451*
- Heaters...*see page 418-420*
- Louvered ventilating plates
...*see page 450*
- Quick release clamp...*see page 427*
- Thermostats...*see page 421-422*
- Window kits...*see page 444*

1422 Series 316 Stainless Steel Two Door Floor Mount - NEMA 4X

Continuous Hinge

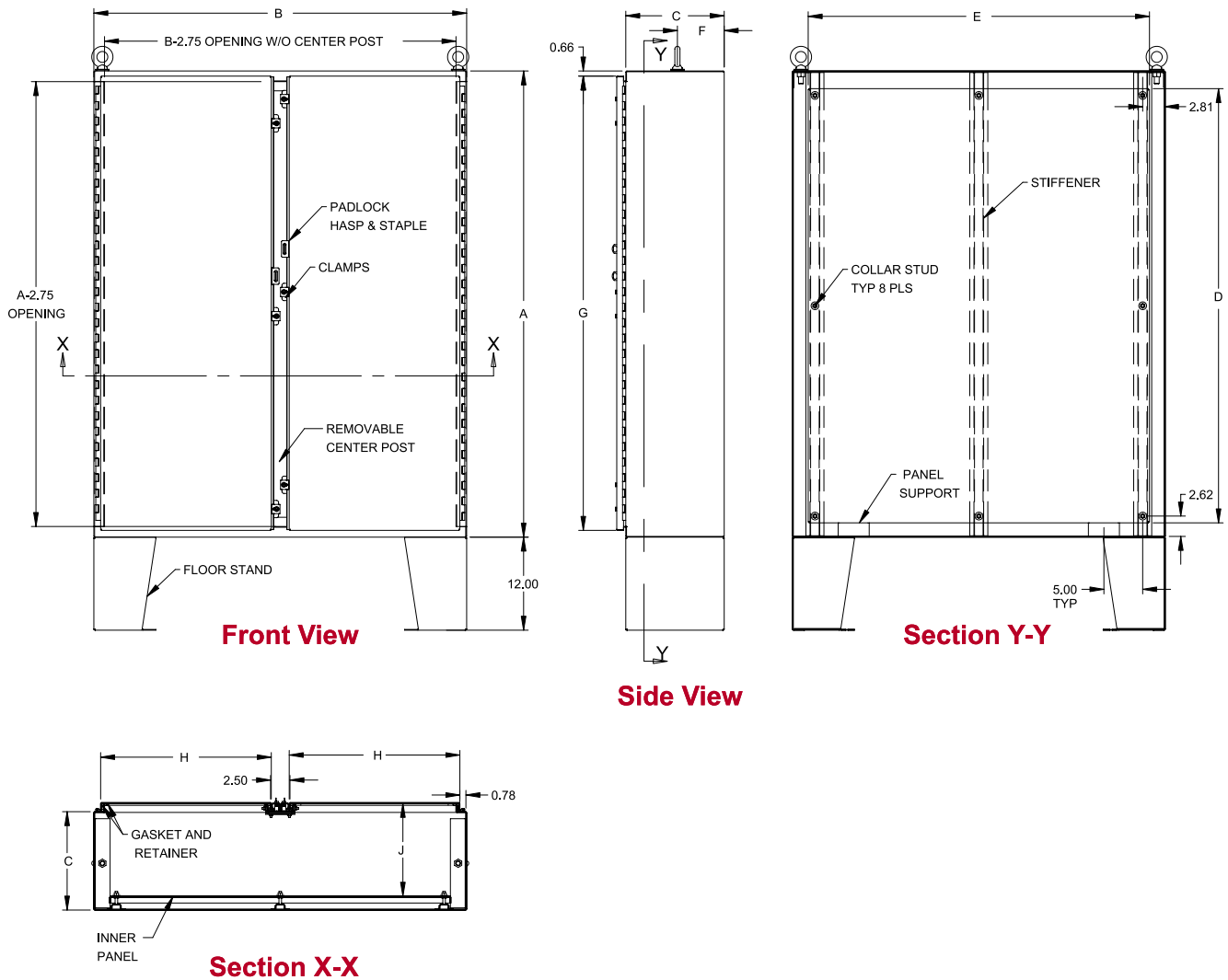

Corrosion Resistant Floormount Enclosures

Part No.	A	B	C	Body Gauge	Panel Gauge	Panel Size		D	E	F	G	H	J	Ship Wt. lbs.
1422N4S16B12F	60.13	48.06	12.69	12	10	56	44	56	44	6.3	58.59	22	11.87	491
1422N4S16D12F	60.13	60.06	12.69	12	10	56	56	56	56	6.3	58.59	28	11.87	567
1422N4S16E12F	72.13	60.06	12.69	12	10	68	56	68	56	6.3	70.59	28	11.87	645
1422N4S16F12F	72.13	72.06	12.69	12	10	68	68	68	68	6.3	70.59	34	11.87	750
1422N4S16F24F	72.13	72.06	24.69	12	10	68	68	68	68	12.3	70.59	34	23.87	945