

Hand Held (1599 Series)

Plastic

Recessed top panel for membrane display or pad...

P.C. card standoffs and vertical card guides molded in...

Flame retardant ABS version includes wear resistant brass bushings...

Flame retardant ABS version includes four machine screws (polystyrene are self-tapping)...

Long life battery door option with our "three snap" location door...

OTHER KEY FEATURES

- Attractively styled and ergonomically designed for use as a "hand-held" instrument enclosure.
- Lap joint construction provides protection against access of dust and splashing water.
- Extra deep top and ultra shallow base are specifically designed to enhance the aesthetics of the enclosure and provide the user with flexibility and assembly efficiency.
- Designed to meet IP54.
- Flame retardant ABS plastic carries a UL flammability rating of 94 V-O.
- Accessory screws for mounting P.C. boards into standoffs P/N **1593ATS50** (qty. 50), P/N **1593ATS100** (qty. 100).
- Two keyhole knockouts are molded into the inside of the base to facilitate wall mount installation.

Fire Retardant ABS Plastic

Part Number	See Size Chart	Color	Battery Door	Belt Clip	Shielded
1599BBK	1599B	Black	-	-	-
1599BGY	1599B	Grey	-	-	-
1599RBBK	1599B	Black	-	-	Yes
1599BBKBAT	1599B	Black	Yes	-	-
1599BGYBAT	1599B	Grey	Yes	-	-
1599BBKCP	1599B	Black	-	Yes	-
1599BGYCP	1599B	Grey	-	Yes	-
1599BBKBATCP	1599B	Black	Yes	Yes	-
1599BGYBATCP	1599B	Grey	Yes	Yes	-
1599EBK	1599E	Black	-	-	-
1599EGY	1599E	Grey	-	-	-
1599REBK	1599E	Black	-	-	Yes
1599EBKBAT	1599E	Black	Yes	-	-
1599EGYBAT	1599E	Grey	Yes	-	-
1599HBK	1599H	Black	-	-	-
1599HGY	1599H	Grey	-	-	-
1599RHBK	1599H	Black	-	-	Yes
1599HBKBAT	1599H	Black	Yes	-	-
1599HGYBAT	1599H	Grey	Yes	-	-
1599KBK	1599K	Black	-	-	-
1599KGY	1599K	Grey	-	-	-
1599KBKBAT	1599K	Black	Yes	-	-
1599KGYBAT	1599K	Grey	Yes	-	-

High Impact Polystyrene

Part Number	See Size Chart	Color	Battery Door
1599BSGY	1599B	Grey	-
1599BSGYBAT	1599B	Grey	Yes
1599ESGY	1599E	Grey	-
1599ESGYBAT	1599E	Grey	Yes
1599HSGY	1599H	Grey	-
1599HSGYBAT	1599H	Grey	Yes
1599KSGY	1599K	Grey	-
1599KSGYBAT	1599K	Grey	Yes

Battery Holder Kits

- Kits include all the parts required to install the batteries
- Kit includes the battery holder, wires, divider and foam anti-rattle pad.

Part Number	Battery holder kit for:
BH1AAWKIT	1 AA Cell
BH2AAWKIT	2 AA Cells
BH1AAAWKIT	1 AAA Cell
BH2AAAWKIT	2 AAA Cells
BH3AAAWKIT	3 AAA Cells
BH4AAAWKIT	4 AAA Cells
BS61KIT	1 - 9V Cell

Hand Held (1599 Series)

Plastic

Body View

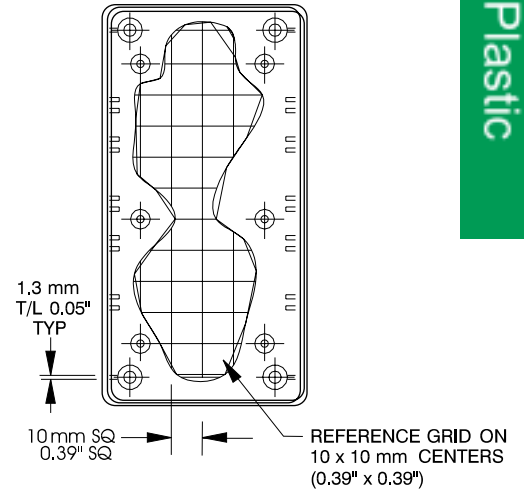
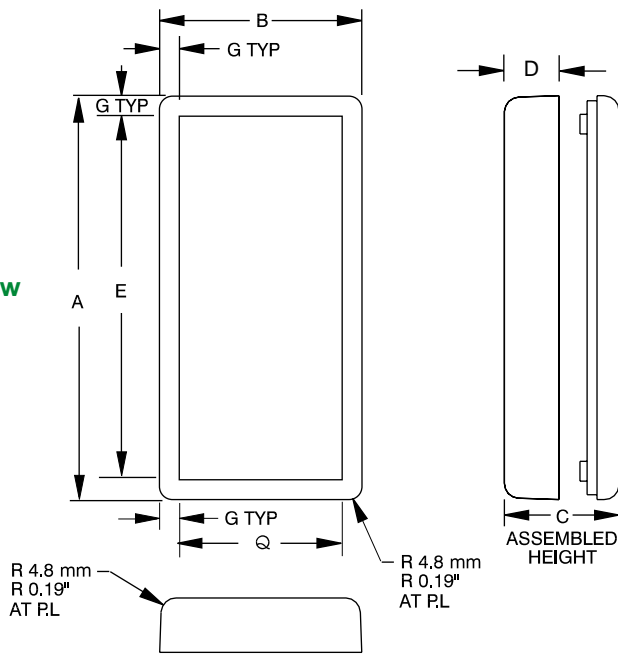

Lid View

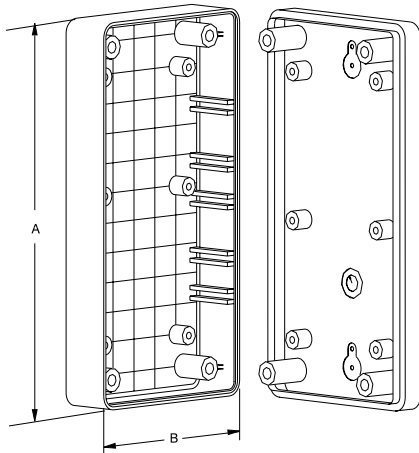
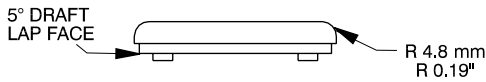
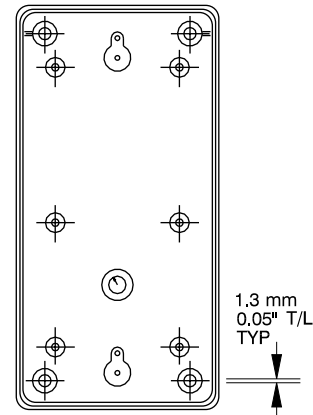
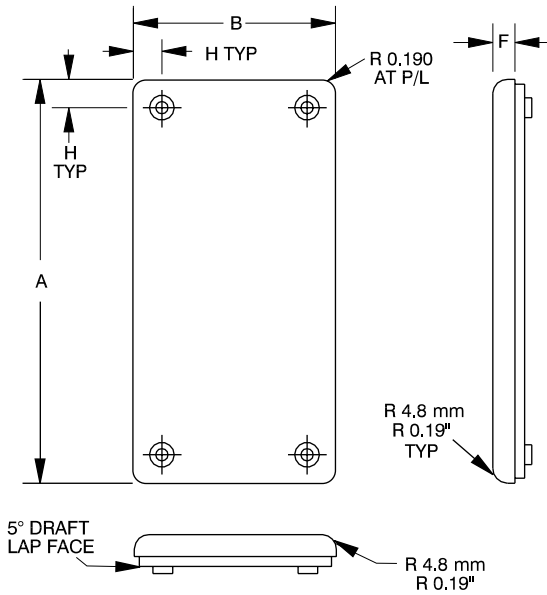

SIZE CHART

Part Number	Units	Dimensions								
		A	B	C	D	F	G	H	Q	E
1599B	inch	5.12	2.56	0.97	0.69	.28	.24	.36	2.06	4.62
	mm	130	65	25	17.5	7	6	9	52.2	117.2
1599E	inch	6.70	3.35	1.33	1.02	.31	.24	.40	2.81	6.16
	mm	170	85	34	26	8	6	10	71	157
1599H	inch	8.66	4.33	1.73	1.38	.35	.24	.44	3.73	8.06
	mm	220	110	44	35	9	6	11	94.8	204.8
1599K	inch	8.66	5.51	1.58	1.19	.35	.24	.44	4.98	8.11
	mm	220	140	40	30	9	6	11	126	206

Short Slope Console (1599 Series)

Plastic



FEATURES (Fire Retardant - ABS Version)

- Attractively styled and ergonomically designed, molded in flame retardant ABS grey or black plastic (material carries a UL flammability rating of 94V-0).
- Rear of units contain one or two (depending on width), removable panels for easy modifications (see our website).
- Two piece lap joint construction provides protection against access of dust and splashing water.
- Designed to meet IP54.
- P.C. board card bosses are molded in for easy installation (see our website).
- Accessory screws for mounting P.C. boards into standoffs P/N **1593ATS50** (qty. 50), P/N **1593ATS100** (qty. 100).
- Base is secured with machine screws into brass bushings for repetitive assembly and disassembly.

Part Number		Rear Panel	P.C. Card Bosses		Units	Dimensions			
Black	Grey		Base	Top		Width	Length	Depth (Rear)	Depth (Front)
1599ETSBK	1599ETSGY	1	6	-	inch mm	3.37 85.5	6.69 170	1.34 34.1	0.73 18.6
1599HTSBK	1599HTSGY	2	6	-	inch mm	4.33 110	8.66 220	1.57 40	0.75 19
1599KTSBK	1599KTSGY	2	8	8	inch mm	5.51 140	8.66 220	1.83 46.5	0.82 20.7

FEATURES (Polystyrene Version)

- Same features as above except molded in economical polystyrene.
- Polystyrene version uses self-tapping screws. Perfect where economy is important and where repetitive assembly and disassembly of lid is not vital.

Part Number	Color	Rear Panel	P.C. Card Bosses		Units	Dimensions			
			Base	Top		Width	Length	Depth (Rear)	Depth (Front)
1599ESTSGY	Grey	1	6	-	inch mm	3.37 85.5	6.69 170	1.34 34.1	0.73 18.6
1599HSTSGY	Grey	2	6	-	inch mm	4.33 110	8.66 220	1.57 40	0.75 19
1599KSTSGY	Grey	2	8	8	inch mm	5.51 140	8.66 220	1.83 46.5	0.82 20.7

Long Slope Console (1599 Series)

Plastic



FEATURES (Fire Retardant - ABS Version)

- Attractively styled and ergonomically designed, molded in flame retardant ABS grey or black plastic (material carries a UL flammability rating of 94V-0).
- Rear of unit contains one removable panel for easy modifications (see our website).
- Two piece lap joint construction provides protection against access of dust and splashing water.
- Designed to meet IP54.
- P.C. board card bosses are molded in for easy installation (see our website).
- Accessory screws for mounting P.C. boards into standoffs P/N **1593ATS50** (qty. 50), P/N **1593ATS100** (qty. 100).
- Base is secured with machine screws into brass bushings for repetitive assembly and disassembly.

Part Number		Battery Door	Rear Panel	P.C. Card Bosses		Units	Dimensions			
Black	Grey			Base	Top		Width	Length	Depth (Rear)	Depth (Front)
1599KTLBK	1599KTLGY	-	1	8	8	inch mm	5.50 140	8.66 220	1.60 40.5	0.71 18
1599KTLBKBAT	1599KTLGYBAT	Yes	1	8	8	inch mm	5.50 140	8.66 220	1.60 40.5	0.71 18

FEATURES (Polystyrene Version)

- Same features as above except molded in economical polystyrene.
- Polystyrene version uses self-tapping screws. Perfect where economy is important and where repetitive assembly and disassembly of lid is not vital.

Part Number	Color	Battery Door	Rear Panel	P.C. Card Bosses		Units	Dimensions			
				Base	Top		Width	Length	Depth (Rear)	Depth (Front)
1599KSTLGY	Grey	-	1	8	8	inch mm	5.50 140	8.66 220	1.60 40.5	0.71 18
1599KSTLGYBAT	Grey	Yes	1	8	8	inch mm	5.50 140	8.66 220	1.60 40.5	0.71 18

Accessories (1599 Series)

ACCESSORIES

Plastic



Replacement Screws for ABS

Machine screw, used in flame retardant ABS 1599B series (ie...with brass inserts).

M3 - 0.5 x 20 mm

1594MS100 - Package of 100

Machine screw, used in flame retardant ABS 1599E, H & K series (ie...with brass inserts).

M3 - 0.5 x 10 mm

1591MS100 - Package of 100



Replacement Screws for Polystyrene

Self-tapping type, used in polystyrene 1599BS series (ie...no brass inserts).

4 x 3/4"

1599BTS100 - Package of 100

Self-tapping type, used in polystyrene 1599ES, HS & KS series (ie...no brass inserts). # 4 x 5/8"

1598TS100 - Package of 100

Battery Holder Kits

- Designed for our battery door enclosures.
- Kits include all the parts required to install the battery or batteries.
- Kit includes the battery holder, wires, divider and foam anti-rattle pad.

Part Number	Battery holder kit for:	Fits Battery Door Enclosure Size:
BH1AAWKIT	1 AA Cell	B, E, H & K
BH2AAWKIT	2 AA Cells	B, E, H & K
BH1AAAWKIT	1 AAA Cell	B, E, H & K
BH2AAAWKIT	2 AAA Cells	B, E, H & K
BH3AAAWKIT	3 AAA Cells	E, H & K
BH4AAAWKIT	4 AAA Cells	E, H & K
BS61KIT	1 - 9V Cell	B, E, H & K

Nylon screws for electrical insulation and strength...



High strength nylon clip for belt or pocket...

Belt or Pocket Clip (for hand held)

Molded from tough nylon, includes 2 nylon screws and mounting template.

Black - **1599CLIP**

Grey - **1599CLIPGY**

P.C. Board Mounting Screws

Self-tapping type, used for bosses in the 1599 series for P.C. board installation. # 4 x 1/4" (6.4 mm)

1593ATS50 - Package of 50

1593ATS100 - Package of 100



Battery Dividers (for hand held)

Grey ABS plastic panel barriers which insert vertically into the P.C. card guides of the 1599B series.

1599BD5 - Package of 5

1599BD100 - Package of 100

Grey ABS plastic panel barriers which insert vertically into the P.C. card guides of the 1599E series.

1599ED5 - Package of 5

1599ED100 - Package of 100

Grey ABS plastic panel barriers which insert vertically into the P.C. card guides of the 1599H series.

1599HD5 - Package of 5

1599HD100 - Package of 100

