

# Extruded With Metal End Plates (1455 Series)

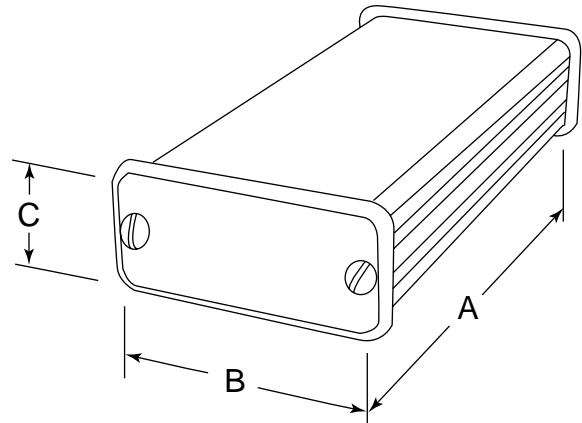

## KEY FEATURES

- Designed to house P.C. boards or for equipment interfacing.
- Sized for standard Eurocards.
- P.C. boards mount horizontally by sliding into internal slots extruded into the enclosure body.
- Rugged body constructed from extruded aluminum with a minimum thickness of .06" (1.5 mm).
- Extruded body includes a slide removable "belly" plate.
- Includes two aluminum end panels (matched to aluminum body finish) and two black plastic bezels. These plastic bezels can be optionally installed to create a modern look.
- Hardware and self-adhesive rubber feet included.

Part Number		Units	A Length	B Width	C Depth
Clear	Black				
1455P1601	1455P1601BK	inch mm	6.30 160	4.74 120.5	1.20 30.5
1455Q1601	1455Q1601BK	inch mm	6.30 160	4.74 120.5	2.03 51.5
1455P2201	1455P2201BK	inch mm	8.66 220	4.74 120.5	1.20 30.5
1455Q2201	1455Q2201BK	inch mm	8.66 220	4.74 120.5	2.03 51.5

# Extruded With Plastic End Panels (1455 Series)

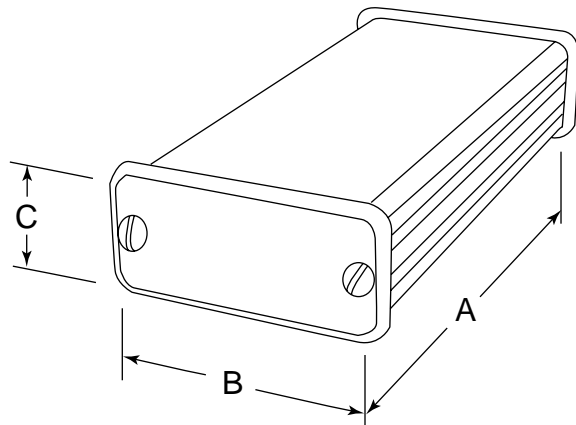

## KEY FEATURES

- Designed to house P.C. boards or for equipment interfacing.
- Sized for standard Eurocards.
- P.C. boards mount horizontally by sliding into internal slots extruded into the enclosure body.
- Rugged body constructed from extruded aluminum with a minimum thickness of .06" (1.5 mm).
- Extruded body includes a slide removable "belly" plate - except the smaller "A" & "B" sizes (i.e. 1455A & 1455B series).
- Smaller sizes ("A" & "B") are rounded for better hand held ergonomics.
- Includes two easy to machine, black solid ABS plastic end panels. Panels are one piece with integral bezel.
- Extruded, anodized aluminum body.
- All hardware and rubber feet are included.

Part Number		Units	A Length	B Width	C Depth
Black	Clear				
1455A802BK	1455A802	inch mm	3.15 80	2.76 70	0.47 12
1455B802BK	1455B802	inch mm	3.15 80	2.82 71.7	0.75 19
1455A1002BK	1455A1002	inch mm	3.94 100	2.76 70	0.47 12
1455B1002BK	1455B1002	inch mm	3.94 100	2.82 71.7	0.75 19
1455A1202BK	1455A1202	inch mm	4.72 120	2.76 70	0.47 12
1455B1202BK	1455B1202	inch mm	4.72 120	2.82 71.7	0.75 19
1455P1602BK	1455P1602	inch mm	6.30 160	4.74 120.5	1.20 30.5
1455Q1602BK	1455Q1602	inch mm	6.30 160	4.74 120.5	2.03 51.5
1455P2202BK	1455P2202	inch mm	8.66 220	4.74 120.5	1.20 30.5
1455Q2202BK	1455Q2202	inch mm	8.66 220	4.74 120.5	2.03 51.5

# Extruded “Sink” Instrument (431609-531623 Series)

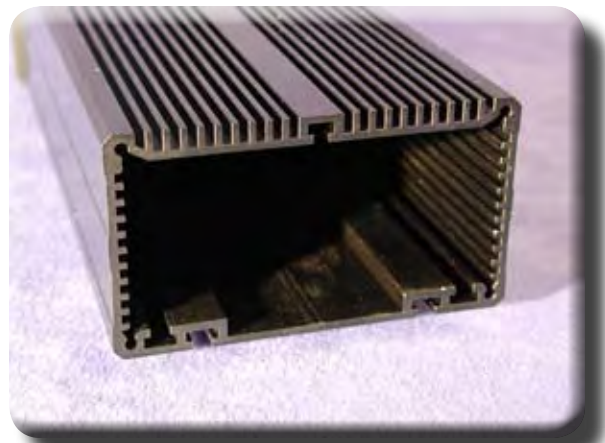

## KEY FEATURES

- The Sink Box series is a British designed extruded aluminum enclosure (originally sold under the West Hyde Enclosures Ltd. name).
- Ideally suited for mounting small printed circuit boards or chassis horizontally.
- The enclosure body is formed from a single, hollow aluminum extrusion. This gives the unit high strength as well as simplifying assembly.
- The aluminum extrusion has fins on one side (the top) which act as a heat sink. Aluminum end panels are attached to each end.
- Extrusions are anodized in a choice of either black or clear.
- The interior of the enclosure contains:
  - \* numerous slots on both of the shorter sides to accept a P.C. board or chassis.
  - \* three “T” slots (one in the top and two in the bottom which provide an alternative method of mounting chassis or components that need to be cooled by conduction).
  - \* the single “T” slot in the top takes an M3 half-nut.
  - \* the two “T” slots in the bottom take M4 half-nuts.
- The exterior of the enclosure contains:
  - \* heat sink fins across the entire top.
  - \* two “T” slots on the bottom to allow mounting of wall brackets, belt attachment or to connect to another enclosure.
  - \* the two bottom “T” slots take M4 half-nuts.
- Also includes molded black plastic bezels which can be used to protect the end panels.
- End panel assembly screws are included.

Part Number		Designed for PC. Board Width of	Units	Length	Width	Depth
Black	Clear					
431609	531609	85mm	inch mm	3.94 100	3.52 90	2.00 51
431612	531612	85mm	inch mm	5.91 150	3.52 90	2.00 51
431610	531610	85mm	inch mm	7.87 200	3.52 90	2.00 51
431611	531611	100mm	inch mm	4.92 125	4.13 105	2.36 60
431621	531621	100mm	inch mm	6.50 165	4.13 105	2.36 60
431622	531622	100mm	inch mm	8.86 225	4.13 105	2.36 60
431623	531623	100mm	inch mm	11.22 285	4.13 105	2.36 60