

Inductive Sensors



Housing Style - Rectangular	Part Number	ID Number	Features	Embeddable	Sensing Range (mm)	Output
CP40 - Embeddable/Nonembeddable, Terminal Chamber 	Bi 15-CP40-VN4X2/S109	M1526900	Time Delay	•	15	4-Wire NPN
	Ni 20-CP40-VN4X2/S109	M1527100	Time Delay		20	
	Bi 15-CP40-VP4X2/S109	M1504721	Time Delay	•	15	4-Wire PNP
	Ni 30-CP40-VP4X2/S109	M1512521	Time Delay		30	
	Bi 15-CP40-VN4X2/S110	M1527000	Time Delay	•	15	4-Wire NPN
	Ni 20-CP40-VN4X2/S110	M1527300	Time Delay		20	
	Bi 15-CP40-VP4X2/S110	M1509821	Time Delay	•	15	4-Wire PNP
	Ni 20-CP40-VP4X2/S110	M1509921	Time Delay		20	
	Bi 15-CP40-FDZ30X2	M4224100	Prog. Outputs	•	15	2-Wire AC/DC
	Bi 15-CP40-FDZ30X2/S34	M4226100	WFI	•	15	
	Bi 15-CP40-FDZ30X2/S97	M4226600	Low Temp. -40°C	•	15	
	Bi 15U-CP40-FDZ30X2	M4280601	Uprox	•	15	
	Ni 20-CP40-FDZ30X2	M4224200	Prog. Outputs		20	
	Ni 35-CP40-FDZ30X2	M4224500	Prog. Outputs		35	
	Ni 40U-CP40-FDZ30X2	M4280801	Uprox		40	
	Bi 15-CP40-FZ3X2	M1341000	Prog. Outputs	•	15	2-Wire AC/DC
	Bi 15-CP40-FZ3X2/S97	M1341010	Low Temp. -40°C	•	15	
	Bi 15-CP40-FZ3X2/S100	M1377600	High Temp. 100°C	•	15	
	Ni 20-CP40-FZ3X2	M1341100	Prog. Outputs		20	
	Ni 20-CP40-FZ3X2/S100	M1377500	High Temp. 100°C		20	
	Ni 20NF-CP40-FZ3X2	M1378200	Prog. Outputs		20	
	Ni 35-CP40-FZ3X2	M1341300	Prog. Outputs		35	
	Ni 40-CP40-FZ3X2/S100	M1374802	High Temp. 100°C			
	Bi 15-CP40-FZ3X2/S109	M1373700	Time Delay	•	15	2-Wire AC
	Bi 15-CP40-FZ3X2/S110	M1373500	Time Delay	•	15	
	Ni 20-CP40-FZ3X2/S109	M1374500	Time Delay		20	
	Ni 20-CP40-FZ3X2/S110	M1374600	Time Delay		20	
	Ni 30-CP40-FZ3X2/S109	M1374700	Time Delay		30	
Ni 30-CP40-FZ3X2/S110	M1374400	Time Delay		30		
Bi 15-CP40-VDZ3X2	M4222700	Comp. Outputs	•	15	4-Wire AC/DC	
Bi 15-CP40-Y1X	M1012000		•	15	NAMUR	
Ni 20-CP40-Y1X	M1012100			20		

WFI = Weld-Field Immune Sensors.
 "/S109" Designates on Delay.
 "/S110" Designates off Delay.

For detailed sensor specifications see Section M.
 Normally Closed versions available upon request, consult factory.



Voltage	Switching Freq. (Hz)	Operating Current (mA)	Operating Temp. (°C)	Protection	Housing	Front Cap/Face	Power LED	Output LED	Mating Cord, Cable Length/Jacket	Wiring Diagram #	Wiring Diagrams
10-65 VDC	- -	≤200	-25 to +70	IP 67	PBT	PBT	GN	YE	- - - -	1	Diagram 1
	- -	≤200	-25 to +70	IP 67	PBT	PBT	GN	YE	- - - -	1	
10-65 VDC	- -	≤200	-25 to +70	IP 67	PBT	PBT	GN	YE	- - - -	2	Diagram 2
	- -	≤200	-25 to +70	IP 67	PBT	PBT	GN	YE	- - - -	2	
10-65 VDC	- -	≤200	-25 to +70	IP 67	PBT	PBT	GN	YE	- - - -	1	Diagram 3
	- -	≤200	-25 to +70	IP 67	PBT	PBT	GN	YE	- - - -	1	
10-300 VDC 20-250 VAC	60	≤400/300	-25 to +70	IP 67	PBT	PBT	GN	YE	- - - -	3	Diagram 4
	30	≤400/300	-25 to +70	IP 67	PBT	PBT	GN	YE	- - - -	3	
	60	≤400/300	-40 to +70	IP 67	PBT	PBT	GN	YE	- - - -	3	
	60	≤400/300	-30 to +85	IP 67	PBT	PBT	GN	YE	- - - -	3	
	60	≤400/300	-25 to +70	IP 67	PBT	PBT	GN	YE	- - - -	3	
	60	≤400/300	-30 to +85	IP 67	PBT	PBT	GN	YE	- - - -	3	
10-300 VDC 20-250 VAC	20	≤400/300	-25 to +70	IP 67	PBT	PBT	GN	YE	- - - -	4	Diagram 5
	20	≤400/300	-40 to +70	IP 67	PBT	PBT	GN	YE	- - - -	4	
	20	≤400/300	-25 to +100	IP 67	PBT	PBT	GN	YE	- - - -	4	
	20	≤400/300	-25 to +70	IP 67	PBT	PBT	GN	YE	- - - -	4	
	20	≤400/300	-25 to +100	IP 67	PBT	PBT	GN	YE	- - - -	4	
	20	≤400/300	0 to +60	IP 67	PBT	PBT	GN	YE	- - - -	4	
	20	≤400/300	-25 to +70	IP 67	PBT	PBT	GN	YE	- - - -	4	
	20	≤400/300	-25 to +100	IP 67	PBT	PBT	GN	YE	- - - -	4	
20-250 VAC	20	≤400/300	-25 to +70	IP 67	PBT	PBT	GN	YE	- - - -	4	Diagram 6
	20	≤400/300	-25 to +70	IP 67	PBT	PBT	GN	YE	- - - -	4	
	20	≤400/300	-25 to +70	IP 67	PBT	PBT	GN	YE	- - - -	4	
	20	≤400/300	-25 to +70	IP 67	PBT	PBT	GN	YE	- - - -	4	
	20	≤400/300	-25 to +70	IP 67	PBT	PBT	GN	YE	- - - -	4	
	20	≤400/300	-25 to +70	IP 67	PBT	PBT	GN	YE	- - - -	4	
20-250 VAC 20-320 VDC	30	≤400/300	-25 to +70	IP 67	PBT	PBT	GN	YE	- - - -	4	
5-30 VDC	150	Remote	-25 to +70	IP 67	PBT	PBT	N/A	YE	- - - -	5	
	150	Remote	-25 to +70	IP 67	PBT	PBT	N/A	YE	- - - -	5	

Rectangular

For material descriptions see page M22.

Inductive Sensors



Housing Style - Rectangular	Part Number	ID Number	Features	Embeddable	Sensing Range (mm)	Output	
CK40 - Embeddable/Nonembeddable, eurofast® Connector 	Bi15-CK40-AD4X-H1141 W/BS2.1	M4465090		•	15	2-Wire DC	
	Ni20-CK40-AD4X-H1141 W/BS2.1	M4465290			20		
	Bi15U-CK40-AN6X2-H1141 W/BS 2.1	M1625690	<i>Uprox</i>	•	15	3-Wire DC NPN	
	Bi15-CK40-AN6X2-H1141 W/BS 2.1	M1625190		•	15		
	Ni20-CK40-AN6X2-H1141 W/BS 2.1	M1625390			20		
	Ni25U-CK40-AN6X2-H1141 W/BS 2.1	M1625789	<i>Uprox</i>		25		
	Ni35U-CK40-AN6X2-H1141 W/BS 4	M1625810	<i>Uprox</i>		35		
	Bi15U-CK40-AP6X2-H1141 W/BS 2.1	M1625689	<i>Uprox</i>	•	15	3-Wire DC PNP	
	Bi15-CK40-AP6X2-H1141 W/BS 2.1	M1625090		•	15		
	Ni20-CK40-AP6X2-H1141 W/BS 2.1	M1625290			20		
	Ni25U-CK40-AP6X2-H1141 W/BS 2.1	M1625790	<i>Uprox</i>		25		
	Ni35U-CK40-AP6X2-H1141 W/BS 4	M1625800	<i>Uprox</i>		35		
	Bi15-CK40-VN4X2-H1141 W/BS 2.1	M1550190	<i>Comp. Outputs</i>	•	15	4-Wire DC NPN	
	Ni20-CK40-VN4X2-H1141 W/BS 2.1	M1550390	<i>Comp. Outputs</i>		20		
	Bi15-CK40-VP4X2-H1141 W/BS 2.1	M1550091	<i>Comp. Outputs</i>	•	15	4-Wire DC PNP	
	Ni20-CK40-VP4X2-H1141 W/BS 2.1	M1550290	<i>Comp. Outputs</i>		20		
	Ni35U-CK40-VP6X2-H1141	M1625815	<i>Uprox</i>		35		
	Bi15-CK40-Y1X-H1141 W/BS 2.1	M4065000			•	15	2-Wire DC NAMUR
	Bi15U-CK40-ASIX2-H1140 W/BS 2.1	M1901088	<i>Uprox</i>		•	15	2-Wire ASI-BUS
	Ni25U-CK40-ASIX2-H1140 W/BS 2.1	M1901089	<i>Uprox</i>		25		

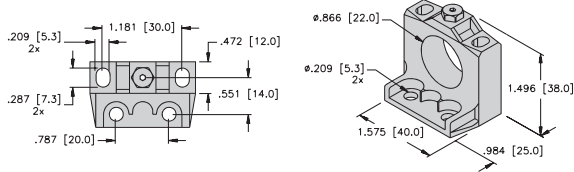

BS 2.1 Mounting Bracket

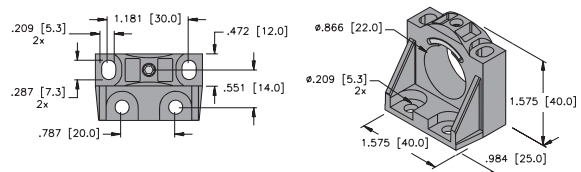

BS 4 Mounting Bracket

For detailed sensor specifications see Section M.
Normally Closed versions available upon request, consult factory.



Voltage	Switching Freq. (Hz)	Operating Current (mA)	Operating Temp. (°C)	Protection	Housing	Front Cap/Face	Power LED	Output LED	Mating Cord, Cable Length/Jacket	Wiring Diagram #	Wiring Diagrams
10-65 VDC	150	≤100	-25 to +70	IP 67	PBT	PBT	GN	YE	RK 4.2T-*	1	Diagram 1
	150	≤100	-25 to +70	IP 67	PBT	PBT	GN	YE	RK 4.2T-*	1	
10-30 VDC	250	≤200	-30 to +85	IP 67	PBT	PBT	GN	YE	RK 4T-*	2	Diagram 2
	150	≤200	-25 to +70	IP 67	PBT	PBT	GN	YE	RK 4T-*	2	
	150	≤200	-25 to +70	IP 67	PBT	PBT	GN	YE	RK 4T-*	2	
	250	≤200	-30 to +85	IP 67	PBT	PBT	GN	YE	RK 4T-*	2	
	250	≤200	-30 to +85	IP 67	PBT	PBT	GN	YE	RK 4T-*	2	
10-30 VDC	250	≤200	-30 to +85	IP 67	PBT	PBT	GN	YE	RK 4T-*	3	Diagram 3
	150	≤200	-25 to +70	IP 67	PBT	PBT	GN	YE	RK 4T-*	3	
	150	≤200	-25 to +70	IP 67	PBT	PBT	GN	YE	RK 4T-*	3	
	250	≤200	-30 to +85	IP 67	PBT	PBT	GN	YE	RK 4T-*	3	
	250	≤200	-30 to +85	IP 67	PBT	PBT	GN	YE	RK 4T-*	3	
10-65 VDC	250	≤200	-25 to +70	IP 67	PBT	PBT	GN	YE	RK 4.4T-*	4	Diagram 4
	250	≤200	-25 to +70	IP 67	PBT	PBT	GN	YE	RK 4.4T-*	4	
10-65 VDC	250	≤200	-25 to +70	IP 67	PBT	PBT	GN	YE	RK 4.4T-*	5	Diagram 5
	250	≤200	-25 to +70	IP 67	PBT	PBT	GN	YE	RK 4.4T-*	5	
	250	≤200	-25 to +70	IP 67	PBT	PBT	GN	YE	RK 4.4T-*	5	
5-30 VDC	150	Remote	-25 to +70	IP 67	PBT	PBT	N/A	YE	RK 4.21T-*	6	Diagram 6
18-33 VDC	200	N/A	-30 to +85	IP 67	PBT	PBT	GN	YE	RKC 254-*M	7	Diagram 7
	200	N/A	-30 to +85	IP 67	PBT	PBT	GN	YE	RKC 254-*M	7	

Rectangular

For material descriptions see page M22.