

Linear Measurement Technology

Linear magnetic displacement sensors WIM Q25L

Dimensions: WIM Q25L series

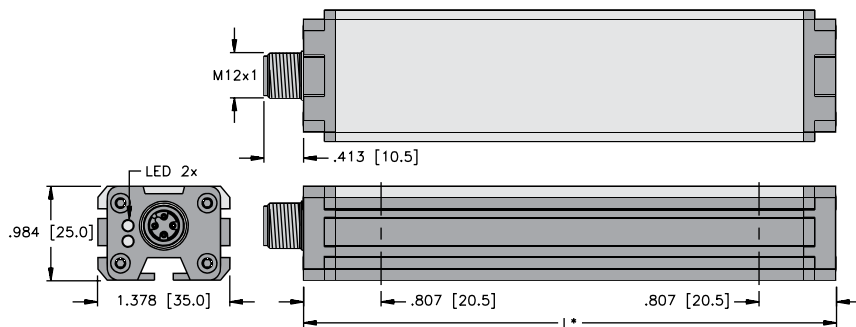

L* = Housing length, see part number key for available lengths..

Wiring Diagram:

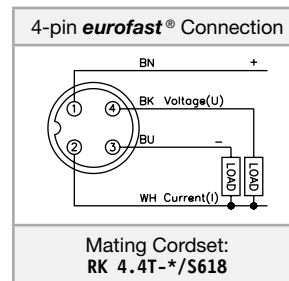

* Length in meters.

Mounting options for WIM Q25L

MB-Q21 brackets are used to mount the sensor on a flat surface.



MB1-Q25 brackets and MN-C sliding blocks can be used to mount the WIM Q25L with the yellow sensing face towards a pneumatic cylinder with parallel T grooves.



Pneumatic cylinder mounting brackets (MB2.1-Q25 or MB2.2-Q25) can be used to mount the WIM Q25 on other styles of pneumatic cylinders.



Sliding blocks (MN-M4-Q25 or MN-M5-Q25) fit in the backside groove. The sliding block is threaded so that you can thread in a bolt to mount the sensor to a bracket. These can also be used with the MB3-Q25 (not shown) to mount the sensor at a right angle to a flat surface if needed.

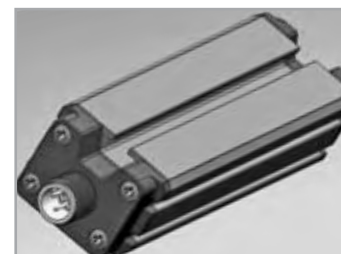

Linear magnetic displacement sensors WIM Q25L accessories

Floating positioning magnet

DM-Q12 [M6900367]

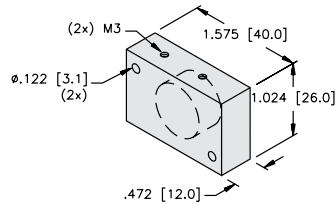

Standard lateral mounting bracket

MB-Q21 [A5700]

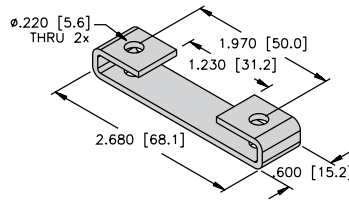

Pneumatic cylinder mounting bracket

MB2.1-Q25 [M6901027]

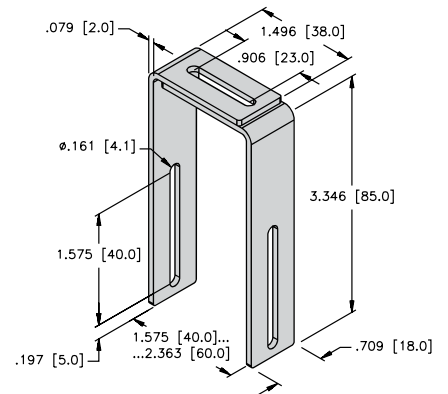

Sliding block for backside sensor profile

MN-M5-Q25 [M6901039]

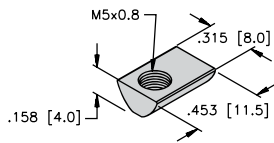

Mounting clip

MB1-Q25 [6901026]

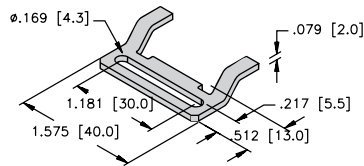

Sliding block for backside sensor profile

MN-M4-Q25 [M6901025]

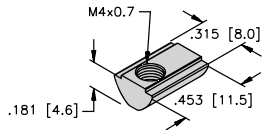

Universal bracket for lateral mounting

MB3-Q25 [M6901029]

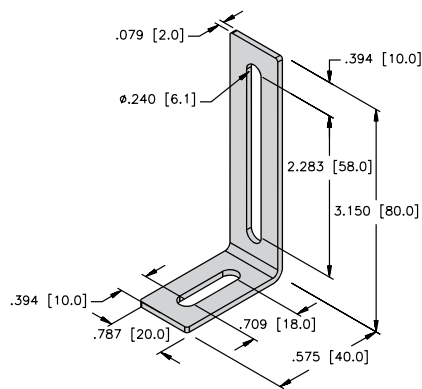

Pneumatic cylinder mounting bracket

MB2.2-Q25 [M6901028]

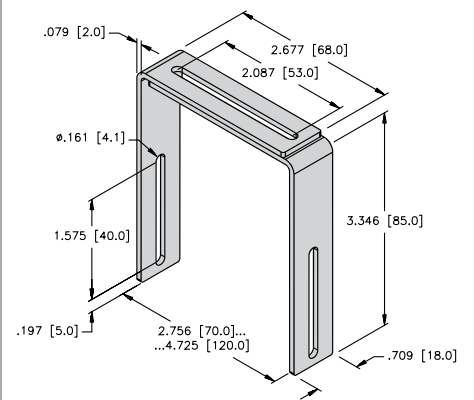

Sliding block for T-groove cylinders

MN-C [M6901024]

