

# Inductive Sensors - Uprox+

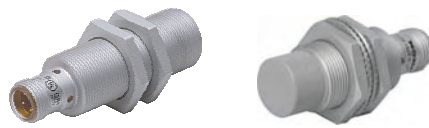

Housing Style	Part Number	ID Number	Features	Sensing Range (mm)	Output
<b>18 mm - Embeddable, eurofast® Connection</b> 	Bi 8U-EM18-AN6X-H1141	M1644738	<i>Uprox+</i> , Stainless steel	8	3-Wire DC NPN
	Bi 8U-M18-AN6X-H1141	M1644737	<i>Uprox+</i>	8	
	Bi 8U-MT18-AN6X-H1141	M1644739	<i>Uprox+</i> , Teflon	8	
	Bi 8U-MT18-AN6X-H1141/S1589	M1644791	<i>Uprox+</i> , Teflon, weldguard	8	
	Bi 8U-EM18-AP6X-H1141	M1644734	<i>Uprox+</i> , Stainless steel	8	3-Wire DC PNP
	Bi 8U-M18-AP6X-H1141	M1644731	<i>Uprox+</i>	8	
	Bi 8U-MT18-AP6X-H1141	M1644730	<i>Uprox+</i> , Teflon	8	
	Bi 8U-MT18-AP6X-H1141/S1589	M1644730-1	<i>Uprox+</i> , Teflon, weldguard	8	
<b>18 mm - Embeddable, eurofast Connection</b> 	Bi 5U-M18M-AD4X-H1144	M4405066	<i>Uprox+</i>	5	2-Wire DC
	Bi 5U-MT18HM-AD4X-H1144/S1589	M4405093	<i>Uprox+</i> , Teflon, weldguard	5	
	Bi 5U-MT18M-AD4X-H1144	M4405068	<i>Uprox+</i> , Teflon	5	
	Bi 8U-EM18E-AP6X-H1141	M1634865	<i>Uprox+</i> , Stainless steel	8	3-Wire DC PNP
	Bi 8U-EM18M-AP6X2-H1141/S1589	M1644771	<i>Uprox+</i> , Stainless steel, weldguard	8	
	Bi 8U-MT18M-AP6X2-H1141	M1644740	<i>Uprox+</i> , Dual LED's	8	
	Bi 8U-MT18M-AP6X2-H1141/S1589	M1644741	<i>Uprox+</i> , Teflon, weldguard	8	
	Bi 8U-M18M-VP44X-H1141	M1634877	<i>Uprox+</i>	8	4-Wire DC PNP
<b>18 mm - Nonembeddable, eurofast Connection</b> 	Ni 15U-EM18-AN6X-H1141	M1635336	<i>Uprox+</i> , Stainless steel	15	3-Wire DC NPN
	Ni 15U-M18-AN6X-H1141	M1635335	<i>Uprox+</i>	15	
	Ni 15U-MT18-AN6X-H1141	M1635337	<i>Uprox+</i> , Teflon	15	
	Ni 15U-MT18-AN6X-H1141/S1589	M16353370	<i>Uprox+</i> , Teflon, weldguard	15	
	Ni 15U-EM18-AP6X-H1141	M1635332	<i>Uprox+</i> , Stainless steel	15	3-Wire DC PNP
	Ni 15U-M18-AP6X-H1141	M1635331	<i>Uprox+</i>	15	
	Ni 15U-MT18-AP6X-H1141	M1635333	<i>Uprox+</i> , Teflon	15	
	Ni 15U-MT18-AP6X-H1141/S1589	M1635333-1	<i>Uprox+</i> , Teflon, weldguard	15	
<b>18 mm - Nonembeddable, Extended Barrel, eurofast Connection</b> 	Ni 10U-M18M-AD4X-H1144	M4405069	<i>Uprox+</i>	15	2-Wire DC
	Ni 10U-MT18M-AD4X-H1144	M4405071	<i>Uprox+</i> , Teflon	15	
	Ni 15U-MT18M-AP6X2-H1141	M1635338	<i>Uprox+</i> , Dual LED's	15	3-Wire DC PNP
	Ni 15U-MT18M-AP6X2-H1141/S1589	M16352920	<i>Uprox+</i> , Dual LED's, weldguard	15	

For detailed sensor specifications see Section M.  
 Normally Closed versions available upon request, consult factory.



Voltage	Switching Freq. (Hz)	Operating Current (mA)	Operating Temp. (°C)	Protection	Housing	Face	Power LED	Output LED	Mating Cordset	Wiring Diagram #	Wiring Diagrams
10-30 VDC	1500	≤200	-30 to +85	IP 68	SS	LCP	N/A	YE	RK 4T-*	1	<p><b>Diagram 1</b></p> <p><b>Diagram 2</b></p> <p><b>Diagram 3</b></p> <p><b>Diagram 3</b></p>
	1500	≤200	-30 to +85	IP 68	CPB	LCP	N/A	YE	RK 4T-*	1	
	1500	≤200	-30 to +85	IP 68	TC	LCP	N/A	YE	RK 4T-*	1	
	1500	≤200	-30 to +85	IP 68	TC	LCP	N/A	YE	RKC 4T-*/S1587	1	
10-30 VDC	1500	≤200	-30 to +85	IP 68	SS	LCP	N/A	YE	RK 4T-*	2	
	1500	≤200	-30 to +85	IP 68	CPB	LCP	N/A	YE	RK 4T-*	2	
	1500	≤200	-30 to +85	IP 68	TC	LCP	N/A	YE	RK 4T-*	2	
	1500	≤200	-30 to +85	IP 68	TC	LCP	N/A	YE	RKC 4T-*/S1587	2	
10-65 VDC	1000	≤200	-30 to +85	IP 68	TC	LCP	N/A	YE	RKC 4T-*/S1587	4	
	1000	≤200	-30 to +85	IP 68	TC	LCP	N/A	YE	RKC 4.23T-*/S1587	4	
	1000	≤200	-30 to +85	IP 68	TC	LCP	N/A	YE	RKC 4T-*/S1587	4	
10-30 VDC	1000	≤200	-30 to +85	IP 68	SS	LCP	N/A	YE	RK 4T-*	2	
	1000	≤200	-30 to +85	IP 68	SS	LCP	N/A	YE	RKC 4T-*/S1587	2	
	1500	≤200	-30 to +85	IP 68	TC	LCP	GN	YE	RK 4T-*	2	
	1000	≤200	-30 to +85	IP 68	TC	LCP	N/A	YE	RKC 4T-*/S1587	2	
10-55 VDC	1500	≤200	-30 to +85	IP 68	CPB	LCP	N/A	YE	RK 4.4T-*	3	
10-30 VDC	1000	≤200	-30 to +85	IP 68	SS	LCP	N/A	YE	RK 4T-*	1	
	1000	≤200	-30 to +85	IP 68	CPB	LCP	N/A	YE	RK 4T-*	1	
	1000	≤200	-30 to +85	IP 68	TC	LCP	N/A	YE	RK 4T-*	1	
	1000	≤200	-30 to +85	IP 68	TC	WG	N/A	YE	RKC 4T-*/S1587	1	
10-30 VDC	1000	≤200	-30 to +85	IP 68	SS	LCP	N/A	YE	RK 4T-*	2	
	1000	≤200	-30 to +85	IP 68	CPB	LCP	N/A	YE	RK 4T-*	2	
	1000	≤200	-30 to +85	IP 68	TC	LCP	N/A	YE	RK 4T-*	2	
	1000	≤200	-30 to +85	IP 68	TC	LCP	N/A	YE	RK 4T-*	2	
10-65 VDC	1000	≤200	-30 to +85	IP 68	CPB	LCP	N/A	YE	RKC 4.23T-*/S1587	4	
	1000	≤200	-30 to +85	IP 68	TC	LCP	N/A	YE	RKC 4.23T-*/S1587	4	
10-30 VDC	1000	≤200	-30 to +85	IP 68	TC	LCP	GN	YE	RK 4T-*	2	
	1000	≤200	-30 to +85	IP 68	TC	LCP	GN	YE	RKC 4T-*/S1587	2	

\* Length in meters.

For material descriptions see page M36.

Uprox+

# Inductive Washdown Sensors *Uprox+*



Housing Style	Part Number	ID Number	Features	Sensing Range (mm)	Output
<b>30 mm - Embeddable, eurofast® Connection</b> 	Bi 15U-EM30WD-AN6X-H1141	M1634834	<i>Uprox+</i> , Washdown	15	3-Wire DC NPN
	Bi 15U-EM30WD-AP6X-H1141	M1634820	<i>Uprox+</i> , Washdown	15	3-Wire DC PNP
<b>30 mm - Nonembeddable, eurofast® Connection</b> 	Ni 30U-EM30WD-AN6X-H1141	M1634832	<i>Uprox+</i> , Washdown	30	3-Wire DC NPN
	Ni 30U-EM30WD-AP6X-H1141	M1634822	<i>Uprox+</i> , Washdown	30	3-Wire DC PNP
<b>30 mm - Embeddable, Potted-in Cable</b> 	Bi 15U-EM30WD-AN6X	M1634843	<i>Uprox+</i> , Washdown	15	3-Wire DC NPN
	Bi 15U-EM30WD-AP6X	M1634819	<i>Uprox+</i> , Washdown	15	3-Wire DC PNP
<b>30 mm - Nonembeddable, Potted-in Cable</b> 	Ni 30U-EM30WD-AN6X	M1634833	<i>Uprox+</i> , Washdown	30	3-Wire DC NPN
	Ni 30U-EM30WD-AP6X	M1634821	<i>Uprox+</i> , Washdown	30	3-Wire DC PNP

For detailed sensor specifications see Section M.  
 Normally Closed versions available upon request, consult factory.



Voltage	Switching Freq. (Hz)	Operating Current (mA)	Operating Temp. (°C)	Protection	Housing	Face	Power LED	Output LED	Mating Cord. Cable Length/Jacket	Wiring Diagram #	Wiring Diagrams
10-30 VDC	750	≤200	-40 to +100	IP 68, 69K	SS	LCP	N/A	YE	RKV 4T-*/S90	1	<p><b>Diagram 1</b></p>
10-30 VDC	750	≤200	-40 to +100	IP 68, 69K	SS	LCP	N/A	YE	RKV 4T-*/S90	2	<p><b>Diagram 2</b></p>
10-30 VDC	500	≤200	-40 to +100	IP 68, 69K	SS	LCP	N/A	YE	RKV 4T-*/S90	1	<p><b>Diagram 3</b></p>
10-30 VDC	500	≤200	-40 to +100	IP 68, 69K	SS	LCP	N/A	YE	RKV 4T-*/S90	2	<p><b>Diagram 4</b></p>
10-30 VDC	750	≤200	-40 to +100	IP 68, 69K	SS	LCP	N/A	YE	2M/PP	3	<p><b>Diagram 3</b></p>
10-30 VDC	750	≤200	-40 to +100	IP 68, 69K	SS	LCP	N/A	YE	2M/PP	4	<p><b>Diagram 4</b></p>
10-30 VDC	500	≤200	-40 to +100	IP 68, 69K	SS	LCP	N/A	YE	2M/PP	3	<p><b>Diagram 3</b></p>
10-30 VDC	500	≤200	-40 to +100	IP 68, 69K	SS	LCP	N/A	YE	2M/PP	4	<p><b>Diagram 4</b></p>

Washdown Uprox+

Harsh Duty

\* Length in meters.

For material descriptions see page M36.

# Inductive Washdown Sensors *Uprox+*

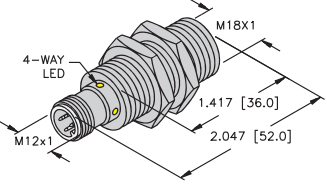
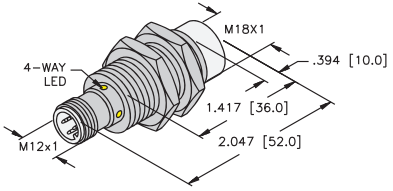
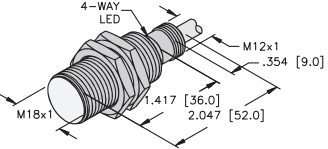
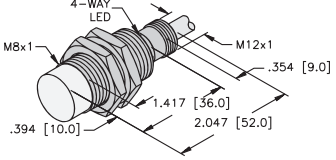

Housing Style	Part Number	ID Number	Features	Sensing Range (mm)	Output
<b>18 mm - Embeddable, eurofast Connection</b> 	Bi 8U-EM18WD-AN6X-H1141	M1634839	<i>Uprox+</i> , Washdown	8	3-Wire DC NPN
	Bi 8U-EM18WD-AP6X-H1141	M1634816	<i>Uprox+</i> , Washdown	8	3-Wire DC PNP
<b>18 mm - Nonembeddable, eurofast Connection</b> 	Ni 15U-EM18WD-AN6X-H1141	M1634835	<i>Uprox+</i> , Washdown	15	3-Wire DC NPN
	Ni 15U-EM18WD-AP6X-H1141	M1634818	<i>Uprox+</i> , Washdown	15	3-Wire DC PNP
<b>18 mm - Embeddable, Potted-in Cable</b> 	Bi 8U-EM18WD-AN6X	M1634840	<i>Uprox+</i> , Washdown	8	3-Wire DC NPN
	Bi 8U-EM18WD-AP6X	M1634815	<i>Uprox+</i> , Washdown	8	3-Wire DC PNP
<b>18 mm - Nonembeddable, Potted-in Cable</b> 	Ni 15U-EM18WD-AN6X	M1634836	<i>Uprox+</i> , Washdown	15	3-Wire DC NPN
	Ni 15U-EM18WD-AP6X	M1634817	<i>Uprox+</i> , Washdown	15	3-Wire DC PNP

For detailed sensor specifications see Section M.  
 Normally Closed versions available upon request, consult factory.



Voltage	Switching Freq. (Hz)	Operating Current (mA)	Operating Temp. (°C)	Protection	Housing	Face	Power LED	Output LED	Mating Cord, Cable Length/Jacket	Wiring Diagram #	Wiring Diagrams
10-30 VDC	1500	≤200	-40 to +100	IP 68, 69K	SS	LCP	N/A	YE	RKV 4T-*/S90	1	<p><b>Diagram 1</b></p>
10-30 VDC	1500	≤200	-40 to +100	IP 68, 69K	SS	LCP	N/A	YE	RKV 4T-*/S90	2	<p><b>Diagram 2</b></p>
10-30 VDC	1000	≤200	-40 to +100	IP 68, 69K	SS	LCP	N/A	YE	RKV 4T-*/S90	1	<p><b>Diagram 3</b></p>
10-30 VDC	1000	≤200	-40 to +100	IP 68, 69K	SS	LCP	N/A	YE	RKV 4T-*/S90	2	<p><b>Diagram 4</b></p>
10-30 VDC	1500	≤200	-40 to +100	IP 68, 69K	SS	LCP	N/A	YE	2M/PP	3	
10-30 VDC	1500	≤200	-40 to +100	IP 68, 69K	SS	LCP	N/A	YE	2M/PP	4	
10-30 VDC	1000	≤200	-40 to +100	IP 68, 69K	SS	LCP	N/A	YE	2M/PP	3	
10-30 VDC	1000	≤200	-40 to +100	IP 68, 69K	SS	LCP	N/A	YE	2M/PP	4	

Washdown Uprox+

Harsh Duty

\* Length in meters.

For material descriptions see page M36.

# Inductive Washdown Sensors *Uprox+*



Housing Style	Part Number	ID Number	Features	Sensing Range (mm)	Output
<b>12 mm - Embeddable, eurofast Connection</b> 	Bi 4U-EM12WD-AN6X-H1141	M1634841	<i>Uprox+, Washdown</i>	4	3-Wire DC NPN
	Bi 4U-EM12WD-AP6X-H1141	M1634812	<i>Uprox+, Washdown</i>	4	3-Wire DC PNP
<b>12 mm - Nonembeddable, eurofast Connection</b> 	Ni 10U-EM12WD-AN6X-H1141	M1634837	<i>Uprox+, Washdown</i>	10	3-Wire DC NPN
	Ni 10U-EM12WD-AP6X-H1141	M1634814	<i>Uprox+, Washdown</i>	10	3-Wire DC PNP
<b>12 mm - Embeddable, Potted-in Cable</b> 	Bi 4U-EM12WD-AN6X	M1634842	<i>Uprox+, Washdown</i>	4	3-Wire DC NPN
	Bi 4U-EM12WD-AP6X	M1634811	<i>Uprox+, Washdown</i>	4	3-Wire DC PNP
<b>12 mm - Nonembeddable, Potted-in Cable</b> 	Ni 10U-EM12WD-AN6X	M1634838	<i>Uprox+, Washdown</i>	10	3-Wire DC NPN
	Ni 10U-EM12WD-AP6X	M1634813	<i>Uprox+, Washdown</i>	10	3-Wire DC PNP

For detailed sensor specifications see Section M.  
 Normally Closed versions available upon request, consult factory.



Voltage	Switching Freq. (Hz)	Operating Current (mA)	Operating Temp. (°C)	Protection	Housing	Face	Power LED	Output LED	Mating Cord, Cable Length/Jacket	Wiring Diagram #	Wiring Diagrams
10-30 VDC	2000	≤200	-40 to +100	IP 68, 69K	SS	LCP	N/A	YE	RKV 4T-*/S90	1	<p><b>Diagram 1</b></p>
10-30 VDC	2000	≤200	-40 to +100	IP 68, 69K	SS	LCP	N/A	YE	RKV 4T-*/S90	2	<p><b>Diagram 2</b></p>
10-30 VDC	1000	≤200	-40 to +100	IP 68, 69K	SS	LCP	N/A	YE	RKV 4T-*/S90	1	<p><b>Diagram 3</b></p>
10-30 VDC	1000	≤200	-40 to +100	IP 68, 69K	SS	LCP	N/A	YE	RKV 4T-*/S90	2	<p><b>Diagram 4</b></p>
10-30 VDC	2000	≤200	-40 to +100	IP 68, 69K	SS	LCP	N/A	YE	2M/PP	3	
10-30 VDC	2000	≤200	-40 to +100	IP 68, 69K	SS	LCP	N/A	YE	2M/PP	4	
10-30 VDC	1000	≤200	-40 to +100	IP 68, 69K	SS	LCP	N/A	YE	2M/PP	3	
10-30 VDC	1000	≤200	-40 to +100	IP 68, 69K	SS	LCP	N/A	YE	2M/PP	4	

Washdown Uprox+

Harsh Duty

\* Length in meters.

For material descriptions see page M36.