

Inductive  
Rectangular Sensors

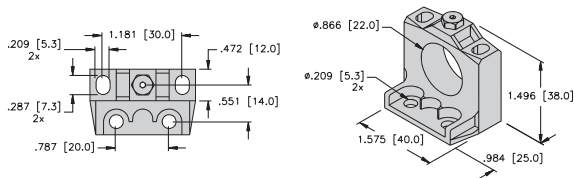

Housing Style - Rectangular	Part Number	ID Number	Features	Embeddable	Sensing Range (mm)	Output
<b>CA40 - Embeddable, eurofast® Connector</b> 	Bi20U-CA40-AN6X2-H1141 W/BS2.1	M1627390	<i>Uprox</i>	•	20	3-Wire DC NPN
	Bi20U-CA40-AP6X2-H1141 W/BS2.1	M1627290	<i>Uprox</i>	•	20	
	Bi20U-CA40-AP6X2-H1141/S1590 W/BS2.0	M1627297	<i>weldguard®</i>	•	20	
	Bi20U-CA40-AP6X2-H1141/S1591 W/BS2.0	M1627296	<i>armorguard®</i>	•	20	
	Bi20U-CA40-AP6X2-H1141/S1591 W/BS2.1	M1627294	<i>armorguard</i>	•	20	
<b>CA40 - Embeddable, minifast® Connector</b> 	Bi20U-CA40-ADZ30X2-B1131 W/BS2.1	M4283290	<i>Uprox</i>	•	20	2-Wire AC/DC Short-Circuit Protected
	Bi20U-CA40-ADZ30X2-B1131/S1669	M4283205	<i>Stoneface®</i>	•	20	
	Bi20-CA40-ADZ30X2-B1131/S34/S1590	M4283593	<i>weldguard</i>	•	20	
	Bi20-CA40-ADZ30X2-B1131/S34/S1591 W/BS2.1	M4283595	<i>armorguard</i>	•	20	
<b>CA40 - Embeddable, microfast® Connector</b> 	Bi20U-CA40-ADZ30X2-B3131 W/BS2.1	M4283292	<i>Uprox</i>	•	20	2-Wire AC/DC Short-Circuit Protected
	Bi20-CA40-ADZ30X2-B3131/S34 W/BS2.1	M4283590		•	20	
	Bi20-CA40-ADZ30X2-B3131/S34/S1590	M4283594	<i>weldguard</i>	•	20	
	Bi20-CA40-ADZ30X2-B3131/S34/S1591 W/BS2.1	M4283596	<i>armorguard</i>	•	20	

Note: 1. BS2.1 is the standard mounting bracket for CA40 unless noted differently.



**BS 2.1 Mounting Bracket**

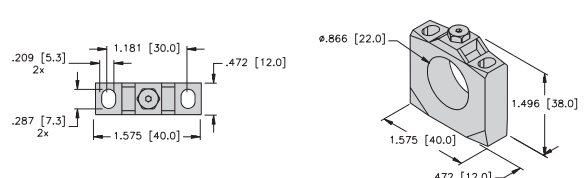

**BS 2.0 Mounting Bracket**

TURCK mold-on connectors available on all cable sensors. See page M25.



Voltage	Switching Freq. (Hz)	Operating Current (mA)	Operating Temp. (°C)	Protection	Housing	Front Cap/Face	Power LED	Output LED	Mating Cord, Cable Length/Jacket	Wiring Diagram #	Wiring Diagrams
10-30 VDC	250	≤200	-30 to +85	IP 67	AL	TP	GN	YE	RK 4T-*	1	<p><b>Diagram 1</b></p>
10-30 VDC	250	≤200	-30 to +85	IP 67	AL	TP	GN	YE	RK 4T-*	2	<p><b>Diagram 2</b></p>
	250	≤200	-30 to +85	IP 67	AL	WG	GN	YE	RK 4T-*	2	
	250	≤200	-30 to +85	IP 67	AG	WG	GN	YE	RK 4T-*	2	
	250	≤200	-30 to +85	IP 67	AG	WG	GN	YE	RK 4T-*	2	
10-300 VDC 20-250 VAC	20	≤400/300	-30 to +85	IP 67	AL	TP	GN	YE	RKM 30-*M	3	<p><b>Diagram 3</b></p>
	20	≤400/300	-30 to +85	IP 67	AL	SF	GN	YE	RKM 30-*M	3	
	20	≤400/300	-25 to +70	IP 67	AL	WG	GN	YE	RKM 30-*M	3	
	20	≤400/300	-25 to +70	IP 67	AG	WG	GN	YE	RKM 30-*M	3	
10-300 VDC 20-250 VAC	20	≤400/300	-30 to +85	IP 67	AL	TP	GN	YE	KB 3T-*	4	<p><b>Diagram 4</b></p>
	20	≤400/300	-25 to +70	IP 67	AL	TP	GN	YE	KB 3T-*	4	
	20	≤400/300	-25 to +70	IP 67	AL	WG	GN	YE	KB 3T-*	4	
	20	≤400/300	-25 to +70	IP 67	AG	WG	GN	YE	KB 3T-*	4	

Rectangular